

洛克赛克保留所有权利。未经授权严禁复制，
使用以及向第三方泄漏。

保密
Confidential

All rights reserved. Unauthorized reproduction, use
or disclosure to third parties is strictly forbidden.

Rev 3.2

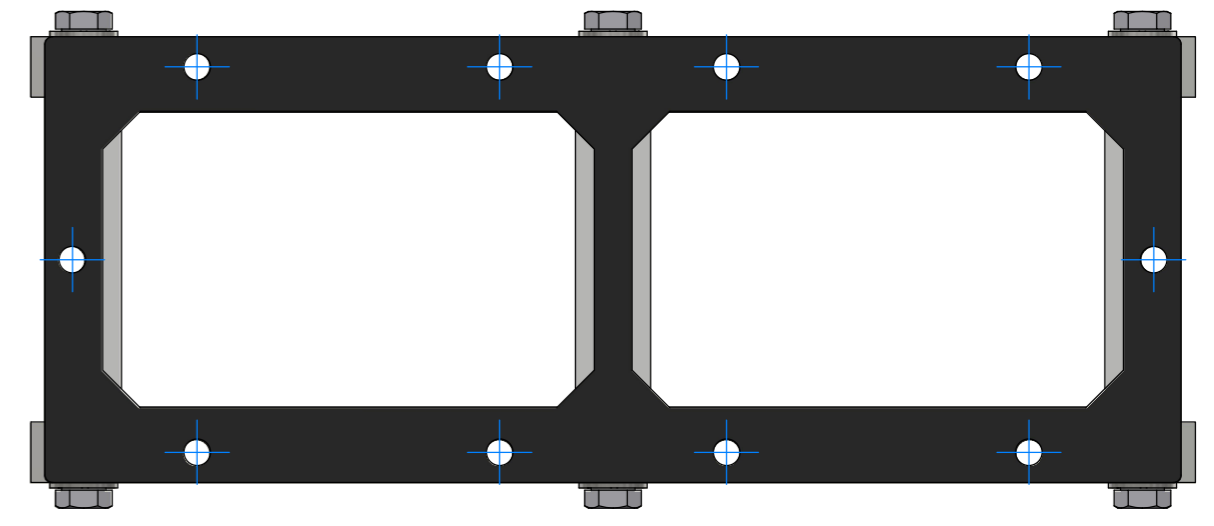
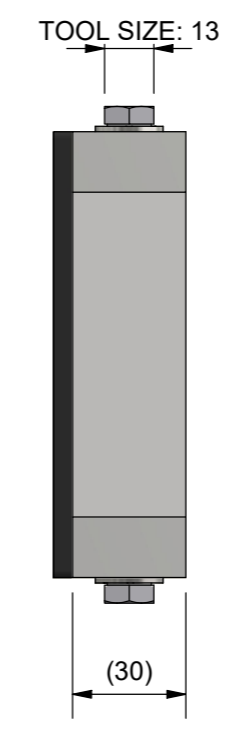
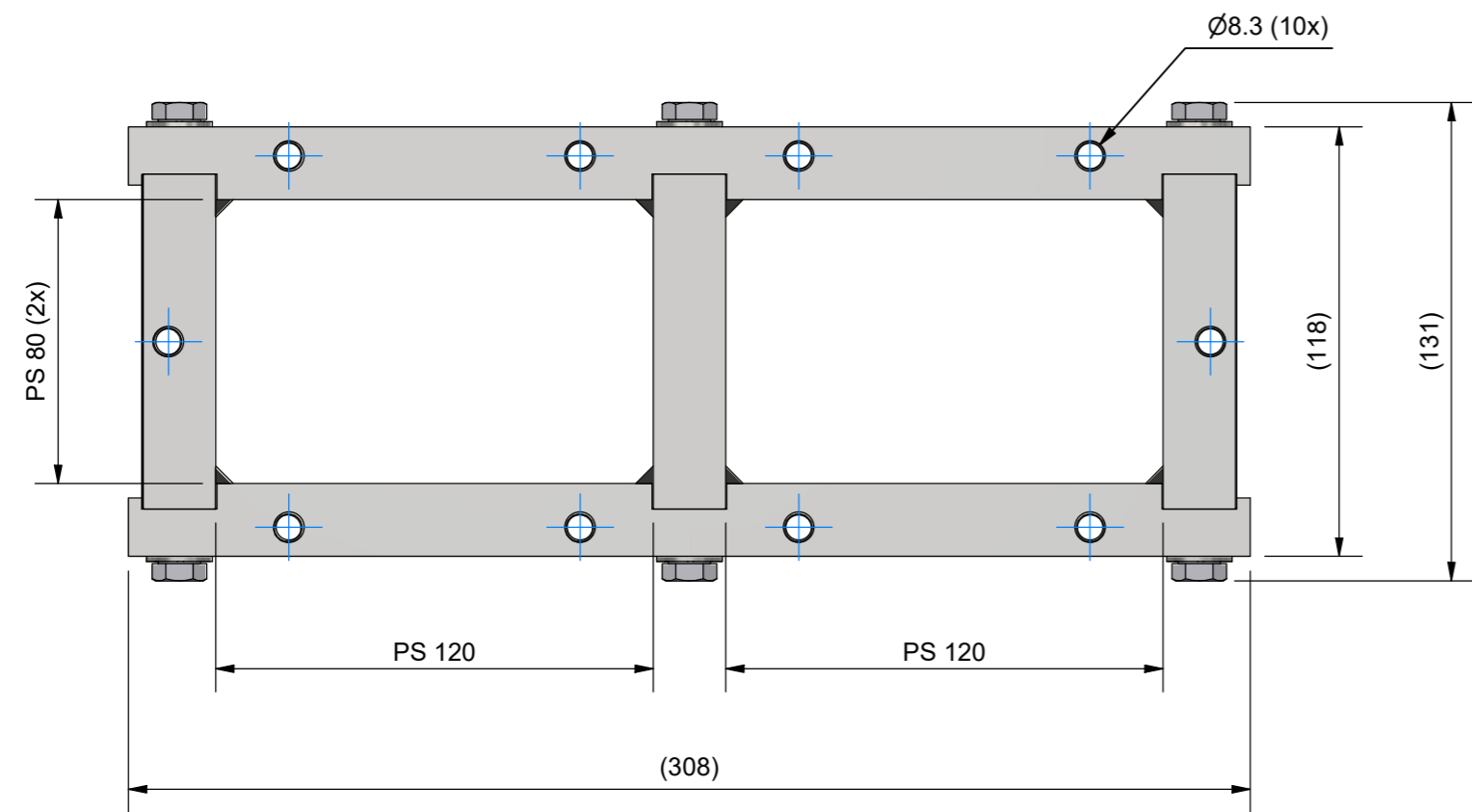

APERTURE DIMENSIONS

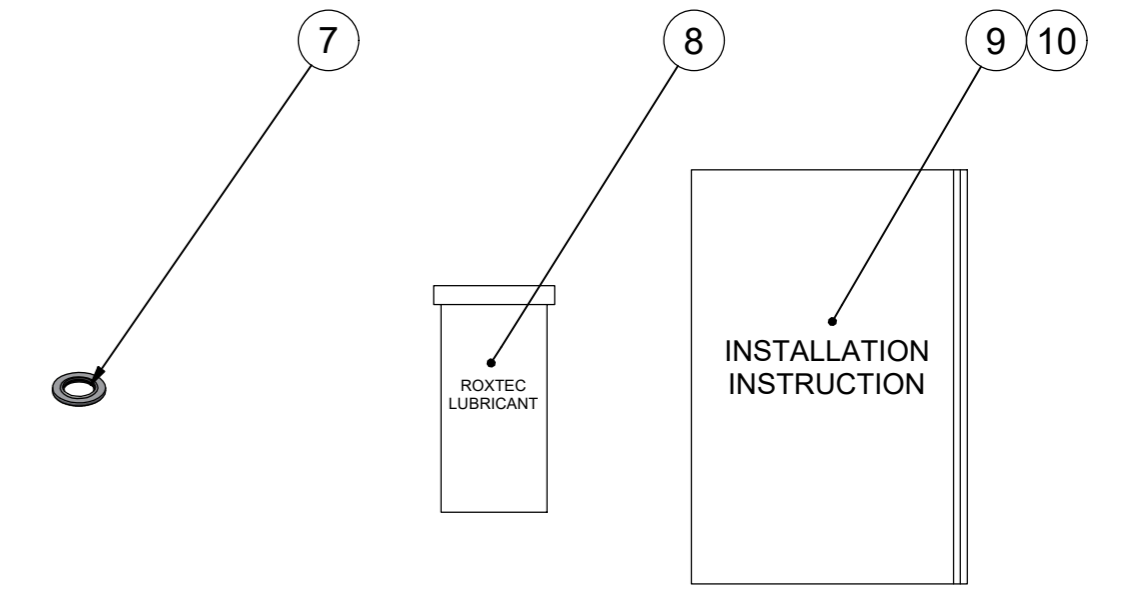
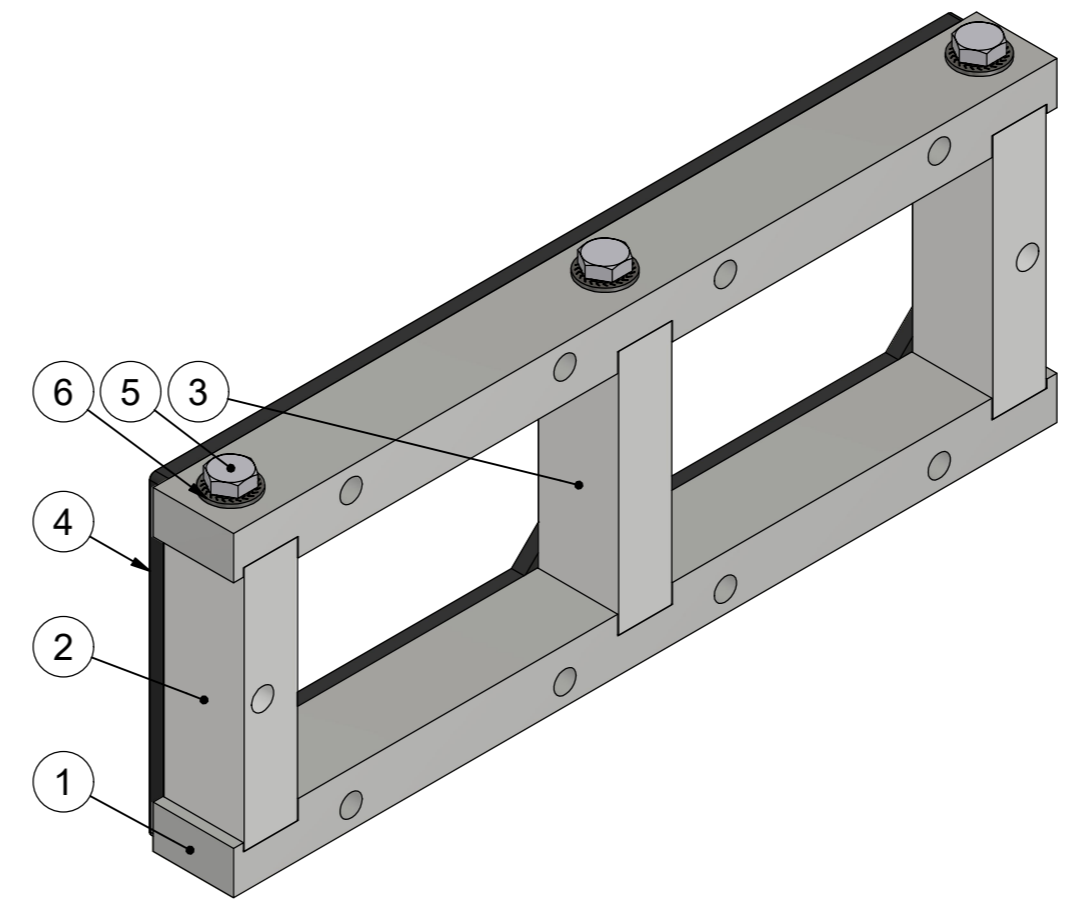
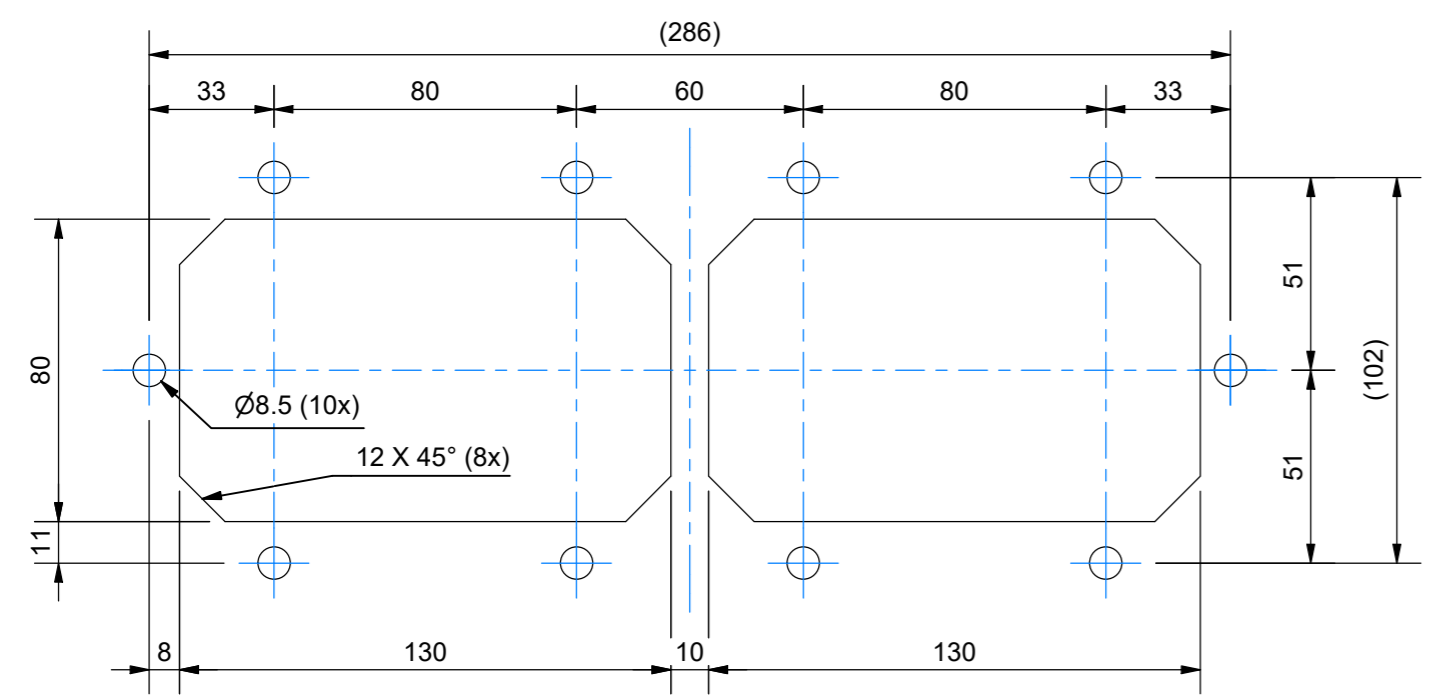

ITEM	QTY	Designation	Specification	Weight
10	1	INSTALLATION INSTRUCTION CM		
9	1	INSTALLATION INSTRUCTION CRF		
8	2	LUBRICANT BLUE		
7	10	SEALING WASHER	M8 A4	
6	6	SERRATED WASHER	NSK-M A4 M8	0
5	6	SCREW	M6S M8x40 ISO 4014 A4-70	0
4	1	GASKET CRF 2x80x120	EPDM CELLULAR RUBBER	0
3	1	CENTER WALL 80	ANODIZED ALUMINUM	0.1
2	2	SHORT SIDE 80	ANODIZED ALUMINUM	0.1
1	2	LONG SIDE 2x120	ANODIZED ALUMINUM	0.4
ITEM QTY		Designation	Specification	Weight
General tolerances used for manufacturing shown in document DOC-002180		Designed by/date se-robgus 2022-04-01	Latest save date 2026-01-27	Format A2
		Scale 1 : 2	Sheet no 1 / 1	TotWeight 1.4 kg
Title CRF 2x80x120 ASSEMBLY		Restricted due to Information drawing		Projection method D
Drawing number S1578383		Rev D		

Rev	Type of revision	Date	Sign
D		2026-01-26	se-marfre

Information drawings show general design and nominal dimensions if not else stated