

KIT	WALL APERTURE (mm)	CABLE RANGE* Ø (mm)	CABLE QTY	MIN. 100 dB ATTENUATION AT FREQUENCY (GHz)	MODULE TYPE	N MODULE QTY	SEAL TYPE	THREAD	L (mm)	T (mm)	D (mm)	C (mm)	E (mm)
WGS ES 18GHz/1	17-20	3.6-5	1	18	N/A	N/A	RS 25	3/8"	87	31	32	14	21
WGS ES 10GHz/1	17-20	3.6-9	1	10	N/A	N/A	RS 25	3/8"	104	48	32	14	21
WGS ES 18GHz/4	34-40	3-5	4	18	CM 15	4	C RO 50	1"	92	30	60	30	46
WGS ES 10GHz/4	42-45	3-9	4	10	CM 15	4	C RO 50	1 1/4"	109	47	63	36	55
WGS ES 1GHz/4	48-58	3.5-15	4	1	CM 20w40	2	C RO 70	1 1/2"	95	21	85	41	70
WGS ES 6GHz/4	48-58	3.5-14	4	6	CM 20w40	2	C RO 70	1 1/2"	130	56	85	41	60
WGS ES 10GHz/9	60-63	3.5-9	9	10	CM 13.3w40	3	C RO 70	2"	120	46	85	44	75

*NOTE: CABLE RANGE DIFFERS FROM STANDARD MODULE RANGE

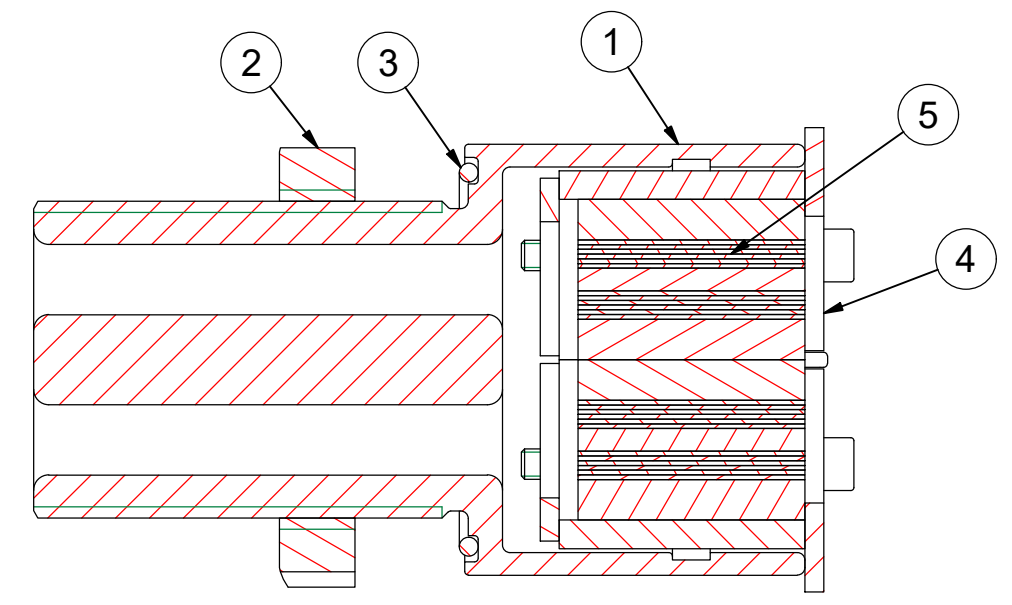

GENERAL DIMENSION VIEW
WGS ES 10GHz/4

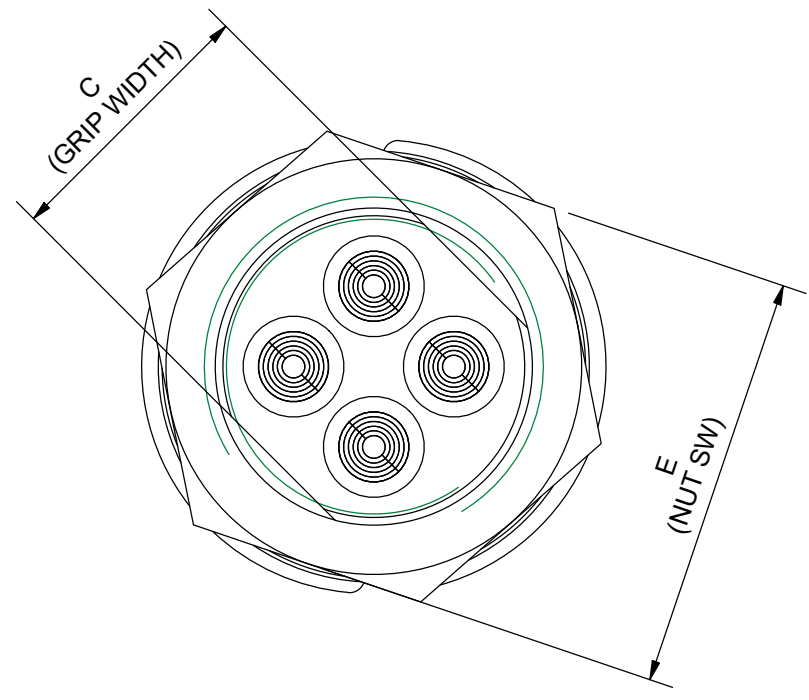
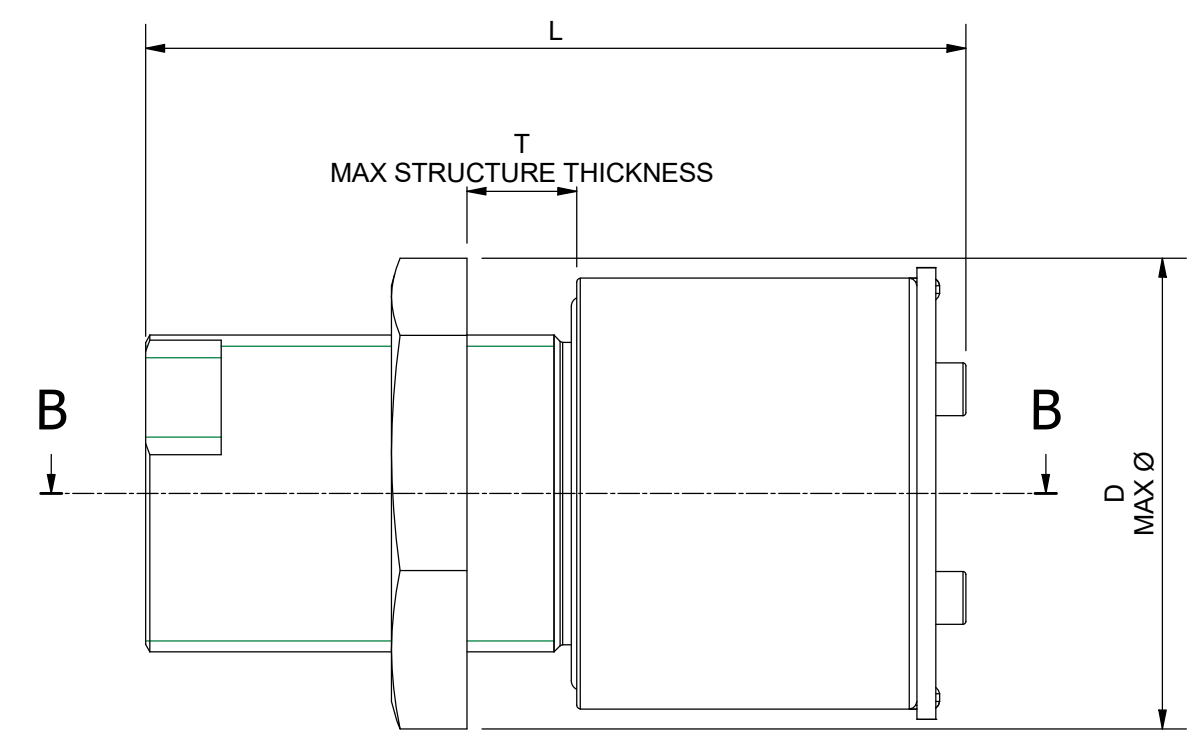
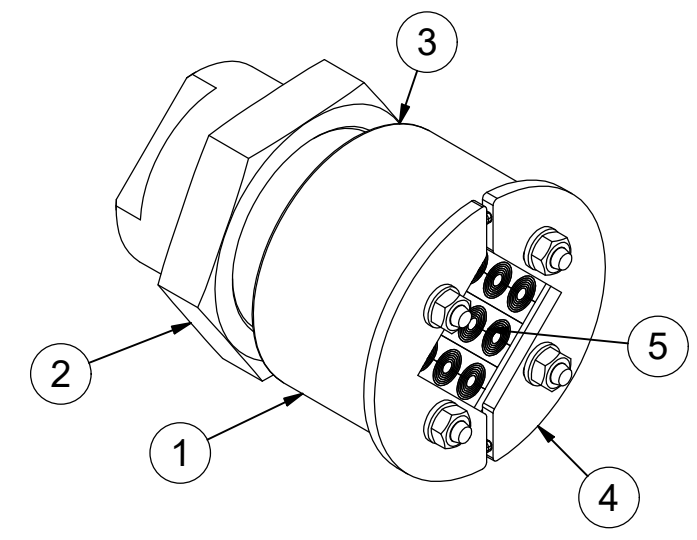
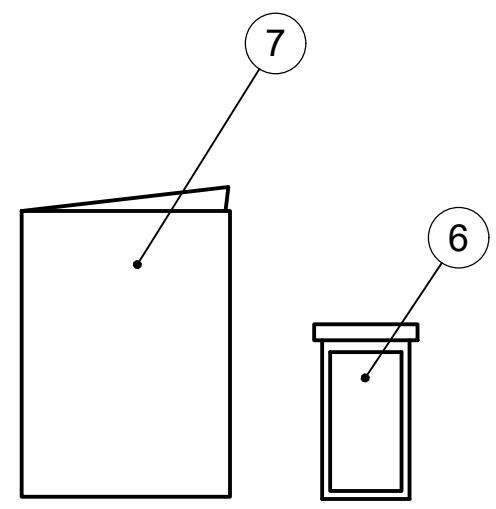

WGS ES 10GHz/9

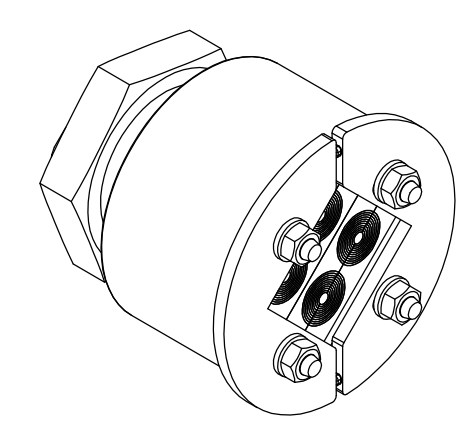

WGS ES 1GHz/4

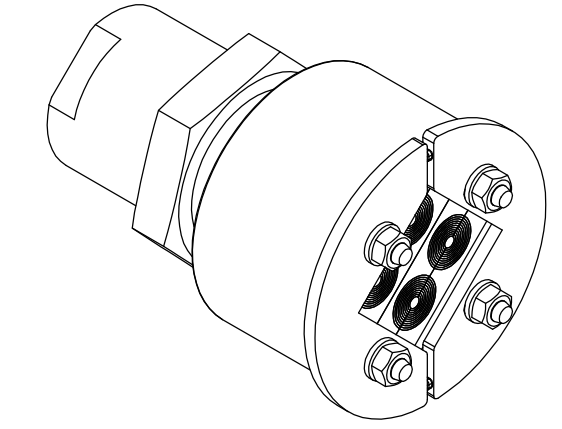

WGS ES 6GHz/4

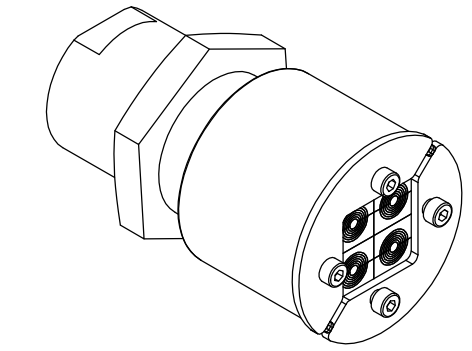

WGS ES 10GHz/4

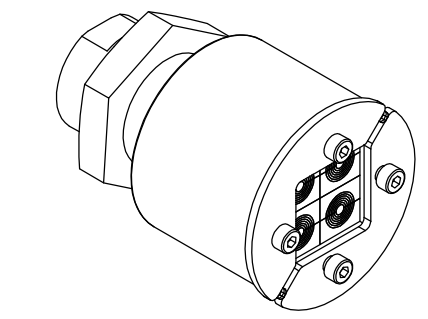

WGS ES 18GHz/4

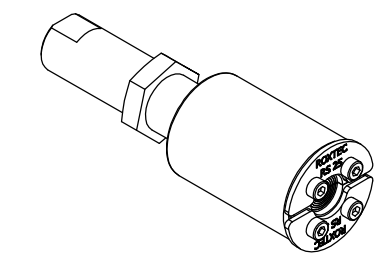

WGS ES 10GHz/1

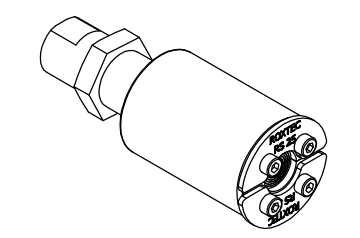

WGS ES 18GHz/1

7	1	INSTALLATION INSTRUCTION											
6	1	LUBRICANT											
5	N	SEALING MODULES	ROXYLON										
4	1	SEALING FRAME	ROXYLON / STAINLESS STEEL										
3	1	O-RING	CONDUCTIVE RUBBER										
2	1	NUT	STAINLESS STEEL										
1	1	WGS ES SLEEVE BOLTED	STAINLESS STEEL										
ITEM	QTY	Designation	Specification		Weight								
General tolerances used for manufacturing shown in document DOC-002180		Designed by/date se-danstr 2021-12-02	Latest save date 2021-12-17	Format A2	Scale	Sheet no 1 / 1	TotWeight 1,0 kg						
Title WGS ES BOLTED ASSEMBLY		Restricted due to Information drawing		Drawing number S1574122		Rev A							
www.roxtec.com		Roxtec		Projection method 1st angle									

Rev	Type of revision	Date	Sign
A		2021-12-02	se-danstr