

SIZE/TYPE	H1 (mm)
2x1	273
4x1	331,5
6x1	390
8x1	450
2+2x1	384
4+4x1	501
6+6x1	618
8+8x1	738
2+2+2x1	495
4+4+4x1	670,5
6+6+6x1	846
8+8+8x1	1026
2+2+2+2x1	606
4+4+4+4x1	840
6+6+6+6x1	1074
8+8+8+8x1	1314
SIZE/TYPE	W1 (mm)
Nx1	292,5

SIZE/TYPE	H1 (mm)
2xN	273
4xN	331,5
6xN	390
8xN	450
2+2xN	386
4+4xN	503
6+6xN	620
8+8xN	740
2+2+2xN	499
4+4+4xN	674,5
6+6+6xN	850
8+8+8xN	1030
2+2+2+2xN	612
4+4+4+4xN	846
6+6+6+6xN	1080
8+8+8+8xN	1320

SIZE/TYPE	W1 (mm)
x2	423
x3	553,5
x4	684
x5	814,5
x6	945
x7	1075,5
x8	1206
x9	1336,5
x10	1467
x11	1597,5
x12	1728
x13	1858,5
x14	1989
x15	2119,5
x16	2250
x17	2380,5
x18	2511
x19	2641,5
x20	2772
x21	2902,5
x22	3033
x23	3163,5
x24	3294
x25	3424,5

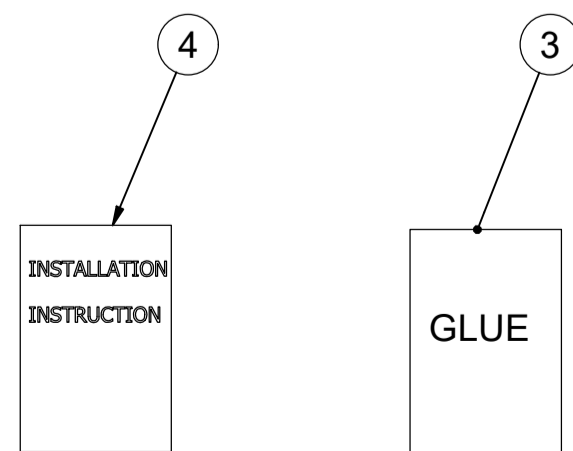
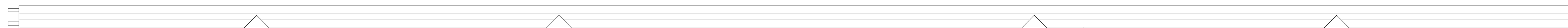
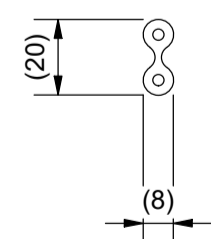

4	1	INSTALLATION INSTRUCTION												
3	1	GLUE												
2	1	BUTYL STRIP Ø4												
1	1	TSL 20x8 RUBBER PROFILE	ROXYLON HE BLUE			0,2								
ITEM	QTY	Designation	Specification	Weight										
<table border="1"> <tr> <td>General tolerances used for manufacturing (shown in document DCC-0013)</td> <td>Designed by: se-ronpet</td> <td>2019-04-03</td> <td>Latest save date: 2021-06-09</td> <td>Format: A1</td> <td>Scale: 1 / 1</td> <td>Sheet no: 1 / 1</td> <td>Weight: 0,2 kg</td> </tr> </table>							General tolerances used for manufacturing (shown in document DCC-0013)	Designed by: se-ronpet	2019-04-03	Latest save date: 2021-06-09	Format: A1	Scale: 1 / 1	Sheet no: 1 / 1	Weight: 0,2 kg
General tolerances used for manufacturing (shown in document DCC-0013)	Designed by: se-ronpet	2019-04-03	Latest save date: 2021-06-09	Format: A1	Scale: 1 / 1	Sheet no: 1 / 1	Weight: 0,2 kg							
		Title: SEALING STRIP ACCESSORIES TSL 20x8 FOR GH FL100			Projection method:		Rev:							
www.roxtec.com		Information drawing		Drawing number: S1542606		Rev: A								

Rev	Type of revision	Date	Sign
A		2019-04-03	se-ronpet