

烙克赛克保留所有权利。未经授权严禁复制、使用以及向第三方泄漏。

All rights reserved. Unauthorized reproduction, use or disclosure to third parties is strictly forbidden.

Rev 3.1

| SIZE | ØD1 (mm) | ØD2 (mm) | ØD3 (mm) | MDM RANGE | A (mm) |
|------------|----------|----------|----------|-----------|--------|
| TB 65 WOC | 65 | 74 | 80 | Ø4-30 | 10 |
| TB 105 WOC | 105 | 114 | 120 | Ø24-54 | 13 |



TB 65 KIT WOC & TB 105 KIT WOC

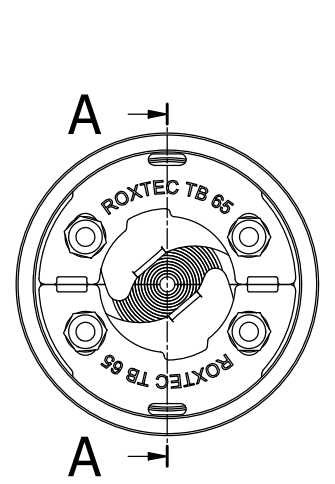

FRONT VIEW:
ROTATIONAL
FITTINGS CLOSED

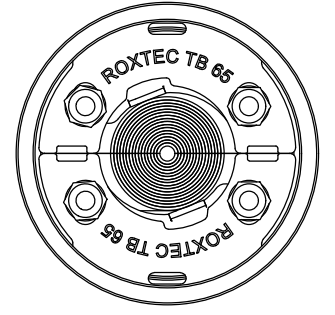

FRONT VIEW:
ROTATIONAL
FITTINGS OPENED

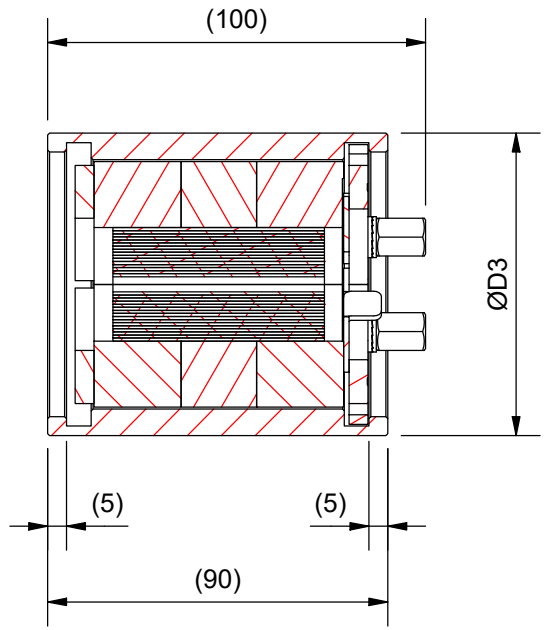

A-A (1 : 2)

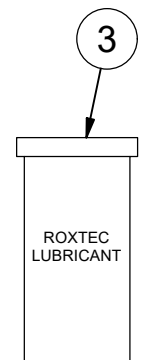
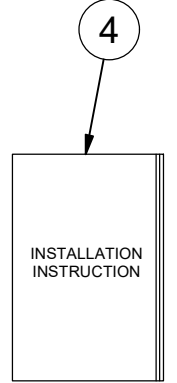
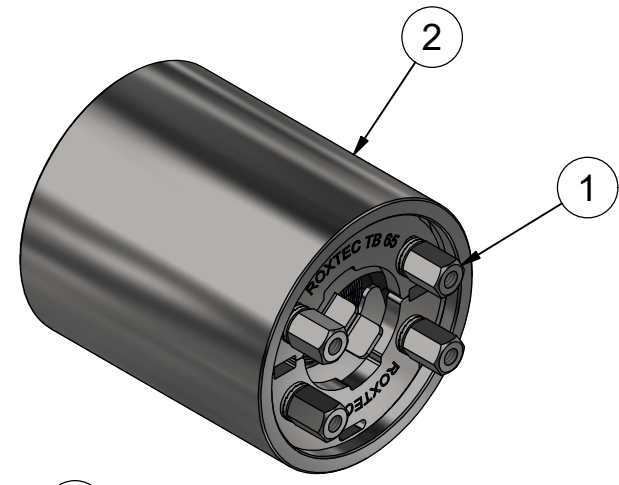
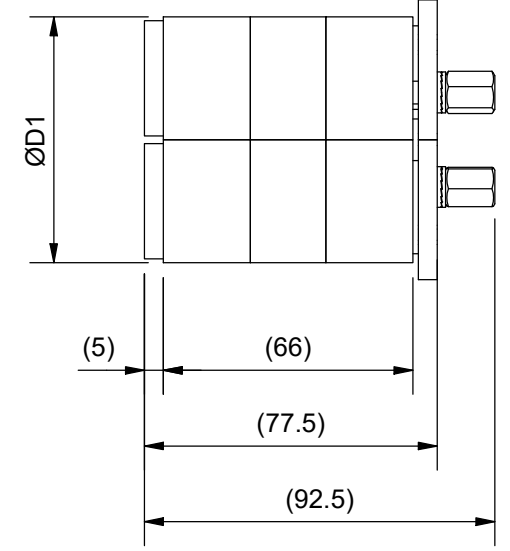
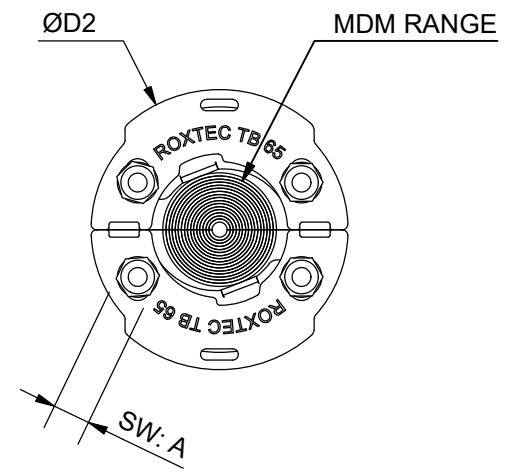

NOTE: THE NAME STANDARD OF THE KIT IS ACCORDING TO:
TB+SIZE+COMPONENT MATERIAL+WOC/SLEEVE MATERIAL
EXAMPLE: TB 65 KIT AISI316 WOC/PRIMED

| ITEM | QTY | Designation | Specification | Weight |
|------|-----|--------------------------|------------------------------------|--------|
| 4 | 1 | INSTALLATION INSTRUCTION | | |
| 3 | 1 | LUBRICANT | | |
| 2 | 1 | SLTB SLEEVE | | |
| 1 | 1 | TB SEAL | ROXYLON/ACID PROOF STAINLESS STEEL | |

| General tolerances used for manufacturing shown in document DOC-002180 | | Designed by/date | Latest save date | Format | Scale | Sheet no | TotWeight |
|--|--|--|------------------|---------------------|-------|----------------|-------------------|
| | | se-micein | 2017-02-08 | A3 | | 1 / 1 | - |
| | | TB KIT TB 65 WOC & TB 105 WOC | | | | | Projection method |
| www.roxtec.com | | Restricted due to | | Information drawing | | Drawing number | Rev |
| | | | | S1519489 | | K | |

| | | | |
|-----|-------------------------------|------------|-----------|
| K | TB 65 NEW RANGE, MDM CENTERED | 2024-09-03 | se-axejon |
| Rev | Type of revision | Date | Sign |

Information drawings show general design and nominal dimensions if not else stated