

SINGLE FRAME

TYPE	L (mm)
GH FL100 / GH BG FL100 2x1	2646
GH FL100 / GH BG FL100 4x1	2880
GH FL100 / GH BG FL100 6x1	3114
GH FL100 / GH BG FL100 8x1	3354

COMBINATION FRAME

TYPE	A (mm)
GH FL100 / GH BG FL100 2xN	1284
GH FL100 / GH BG FL100 4xN	1518
GH FL100 / GH BG FL100 6xN	1752
GH FL100 / GH BG FL100 8xN	1992

COMB xN	B (mm)
x2	1884
x3	2406
x4	2928
x5	3450
x6	3972
x7	4494
x8	5016
x9	5538
x10	6060

L=A+B

+ SINGLE FRAME

TYPE	L (mm)
GH FL100 / GH FL100 BG 2+2x1	3090
GH FL100 / GH FL100 BG 4+4x1	3558
GH FL100 / GH FL100 BG 6+6x1	4026
GH FL100 / GH FL100 BG 8+8x1	4506
GH FL100 / GH FL100 BG 2+2+2x1	3534
GH FL100 / GH FL100 BG 4+4+4x1	4236
GH FL100 / GH FL100 BG 6+6+6x1	4938
GH FL100 / GH FL100 BG 8+8+8x1	5658
GH FL100 / GH FL100 BG 2+2+2+2x1	3978
GH FL100 / GH FL100 BG 4+4+4+4x1	4914
GH FL100 / GH FL100 BG 6+6+6+6x1	5850
GH FL100 / GH FL100 BG 8+8+8+8x1	6810

+ COMBINATION FRAME

TYPE	A (mm)
GH FL100 / GH BG FL100 2+2xN	1768
GH FL100 / GH BG FL100 4+4xN	2236
GH FL100 / GH BG FL100 6+6xN	2704
GH FL100 / GH BG FL100 8+8xN	3184
GH FL100 / GH BG FL100 2+2+2xN	2252
GH FL100 / GH BG FL100 4+4+4xN	2954
GH FL100 / GH BG FL100 6+6+6xN	3656
GH FL100 / GH BG FL100 8+8+8xN	4376
GH FL100 / GH BG FL100 2+2+2+2xN	2736
GH FL100 / GH BG FL100 4+4+4+4xN	3672
GH FL100 / GH BG FL100 6+6+6+6xN	4608
GH FL100 / GH BG FL100 8+8+8+8xN	5568

COMB xN	B (mm)
x2	1884
x3	2406
x4	2928
x5	3450
x6	3972
x7	4494
x8	5016
x9	5538
x10	6060

L=A+B

NOTES:

TOTAL SEALING STRIP LENGTH FOR OTHER FRAME TYPES OR SIZES CAN BE DETERMINED BY $L=4 \times H + 4 \times W$ OR TWICE THE CIRCUMFERENCE.

LENGTHS A AND B MUST BE COMBINED FOR THE TOTAL LENGTH (L) OF THE SEALING STRIP.

THE SEALING STRIP IS DELIVERED IN PRE-DEFINED ROLLS. FOR LENGTHS ABOVE 6 METERS, TWO ROLLS MUST BE COMBINED TO MATCH THE TOTAL REQUIRED SEALING STRIP LENGTH.

ARTICLE	LENGTH (mm)
151883	2500
151884	3000
151885	3500
151886	4000
151887	4500
151888	5000
151889	5500
151890	6000

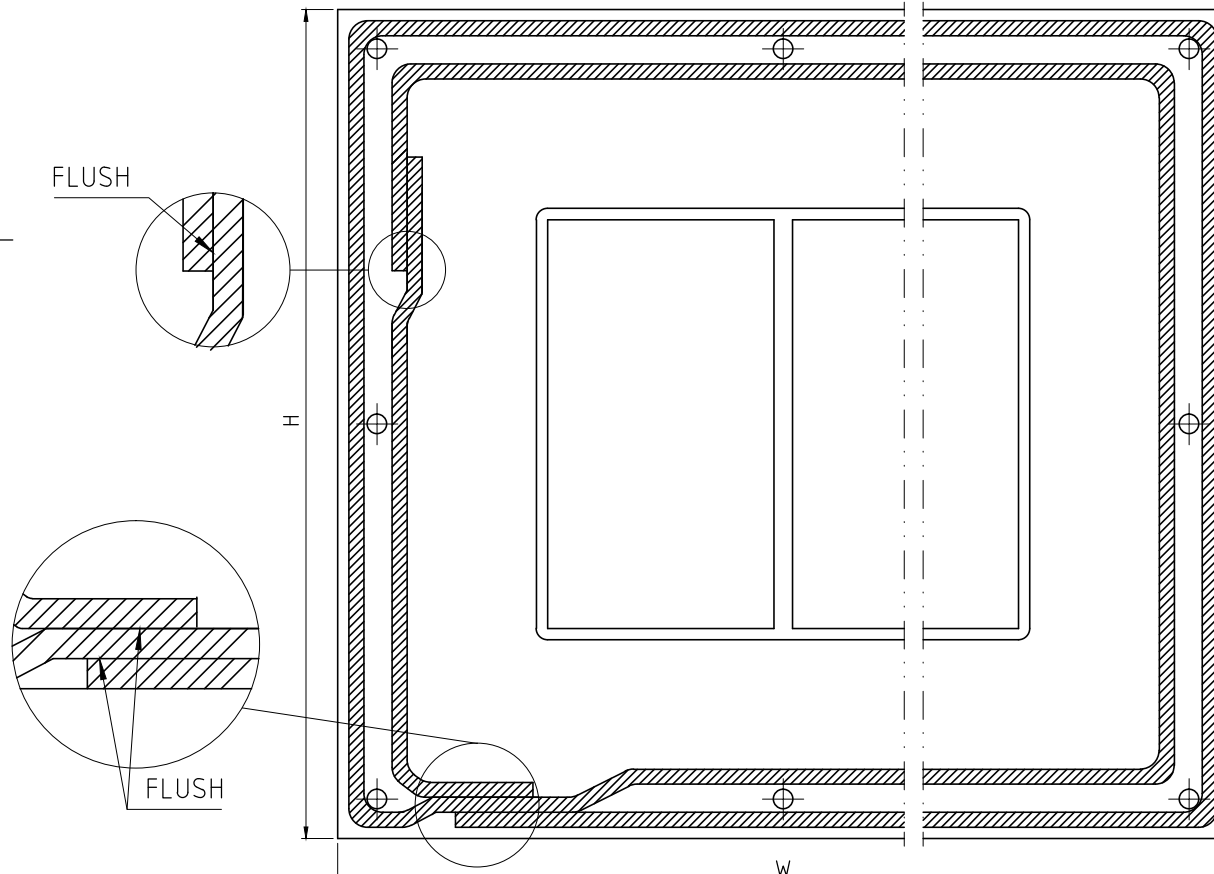
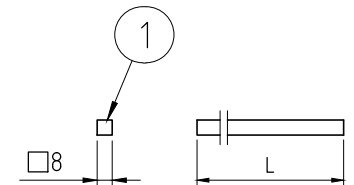

B		2015-02-13	se-jenboh
Rev	Type of revision	Date	Sign

1	-	SEALING STRIP	TSL 8X8 BUTYL, SELF ADHESIVE						
Item	Qty	Designation	Specification	Net Weight					
<table border="0"> <tr> <td><small>General reference ISO 10442-2:2011 EN ISO 10442-2:2011</small></td> <td><small>Material details EN ISO 18171-6 EN ISO 10042-8</small></td> <td><small>General surface EN ISO 10042-8 12.3</small></td> <td> Designed by: se-jenboh Created Date: 2015-02-09 Project save date: 2015-02-13 Format: A2 Scale: 1:2 Sheet no: </td> <td> Net Weight: - Projection method: </td> </tr> </table>					<small>General reference ISO 10442-2:2011 EN ISO 10442-2:2011</small>	<small>Material details EN ISO 18171-6 EN ISO 10042-8</small>	<small>General surface EN ISO 10042-8 12.3</small>	Designed by: se-jenboh Created Date: 2015-02-09 Project save date: 2015-02-13 Format: A2 Scale: 1:2 Sheet no:	Net Weight: - Projection method:
<small>General reference ISO 10442-2:2011 EN ISO 10442-2:2011</small>	<small>Material details EN ISO 18171-6 EN ISO 10042-8</small>	<small>General surface EN ISO 10042-8 12.3</small>	Designed by: se-jenboh Created Date: 2015-02-09 Project save date: 2015-02-13 Format: A2 Scale: 1:2 Sheet no:	Net Weight: - Projection method:					
Title: SEALING STRIP- TSL 8X8 BUTYL GH FL100 / GH BG FL100 Restricted due to Information									
Drawing number: S1501708				Rev: B					

姆克賽克保留所有權利。未經授權嚴禁复制，使用以及向第三方泄瀉。

All rights reserved. Unauthorized reproduction, use or disclosure to third parties is strictly forbidden.