

烙克赛克保留所有权利。未经授权严禁复制，
使用以及向第三方泄漏。

All rights reserved. Unauthorized reproduction, use
or disclosure to third parties is strictly forbidden

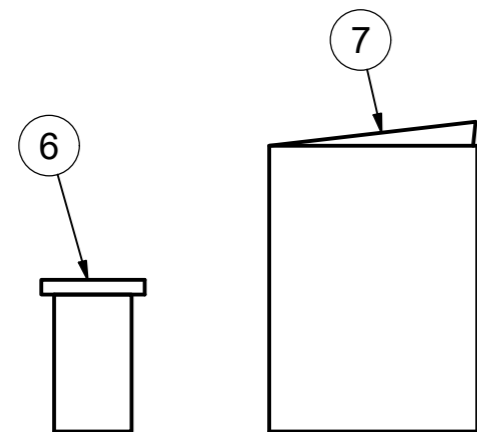
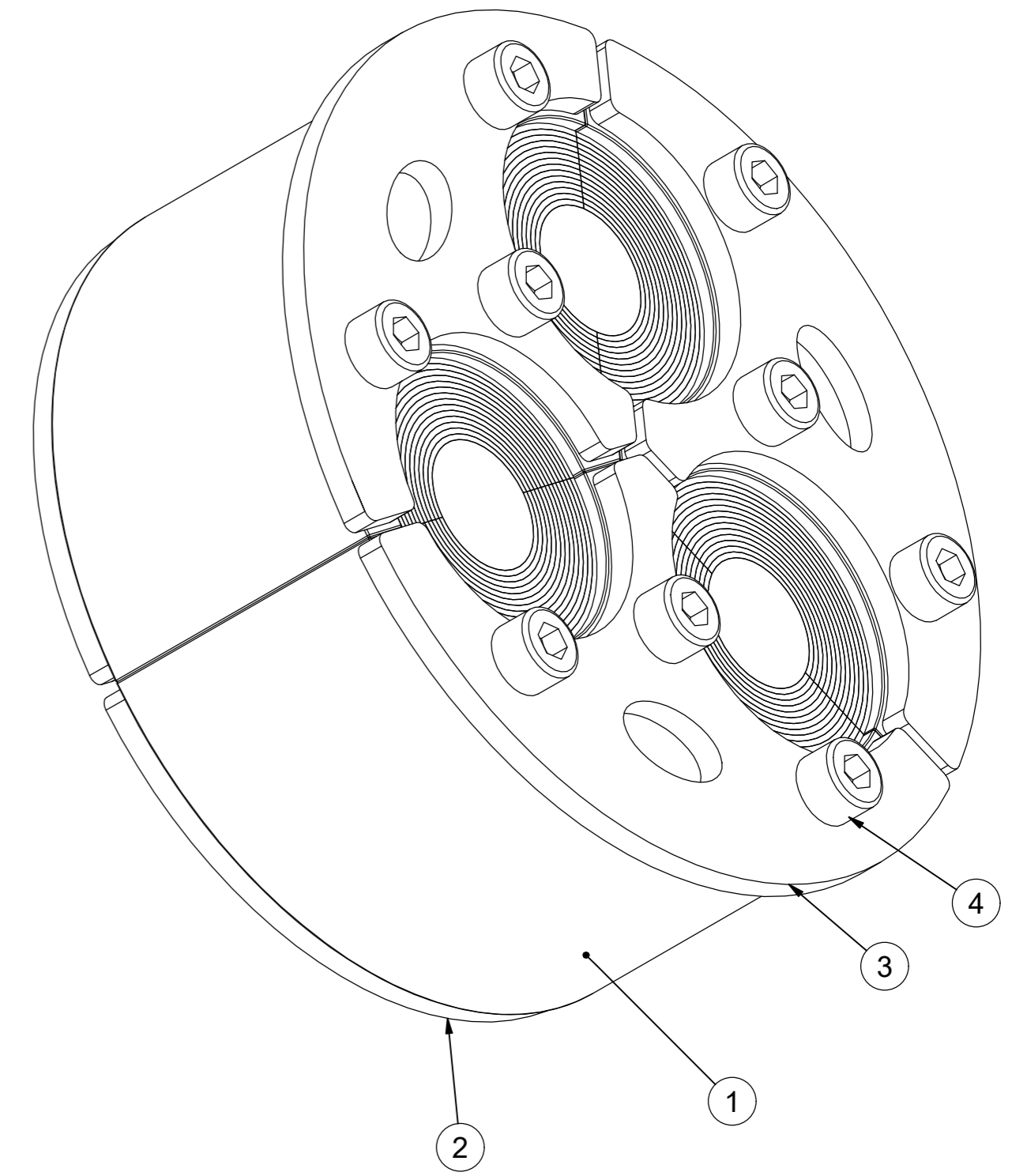
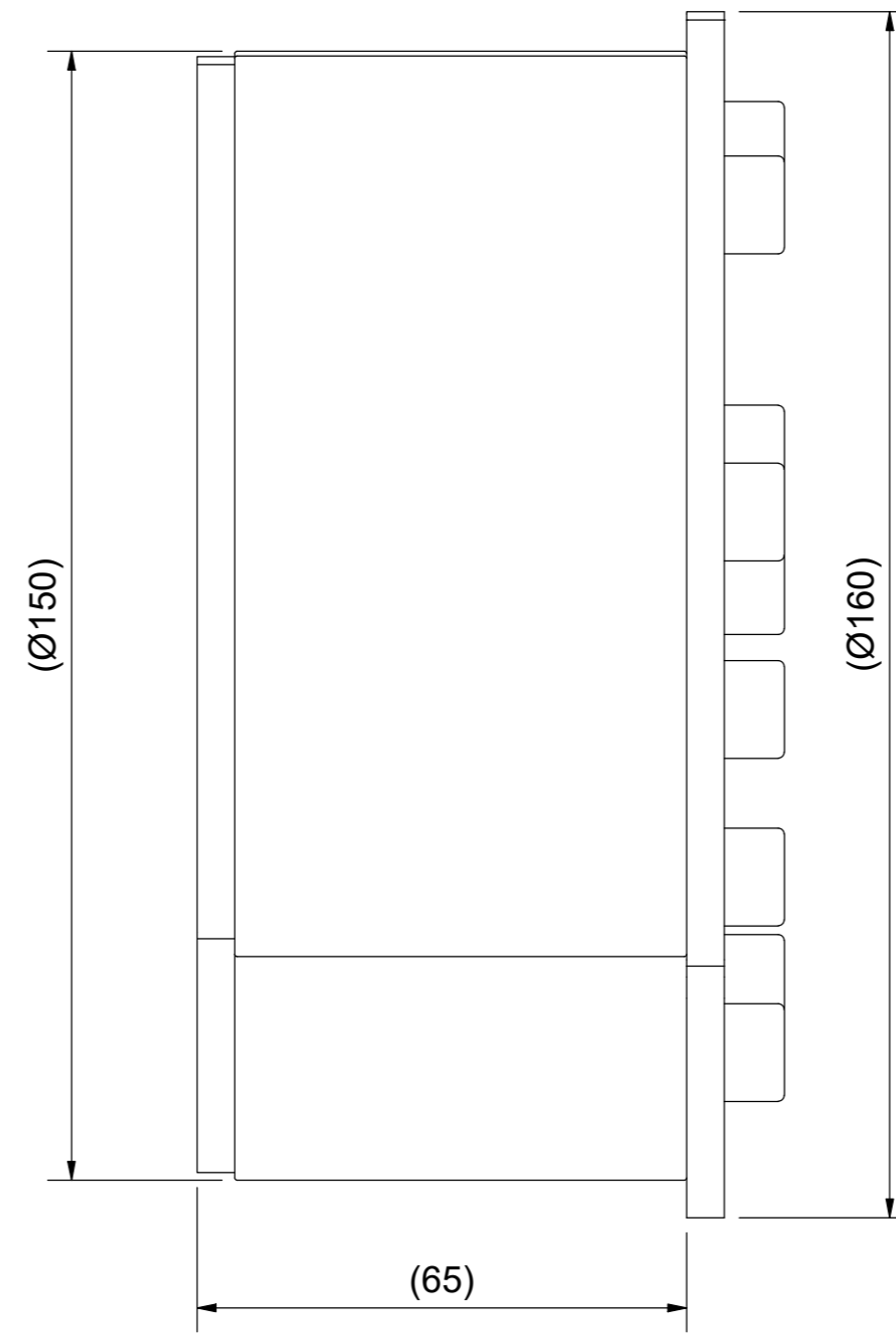
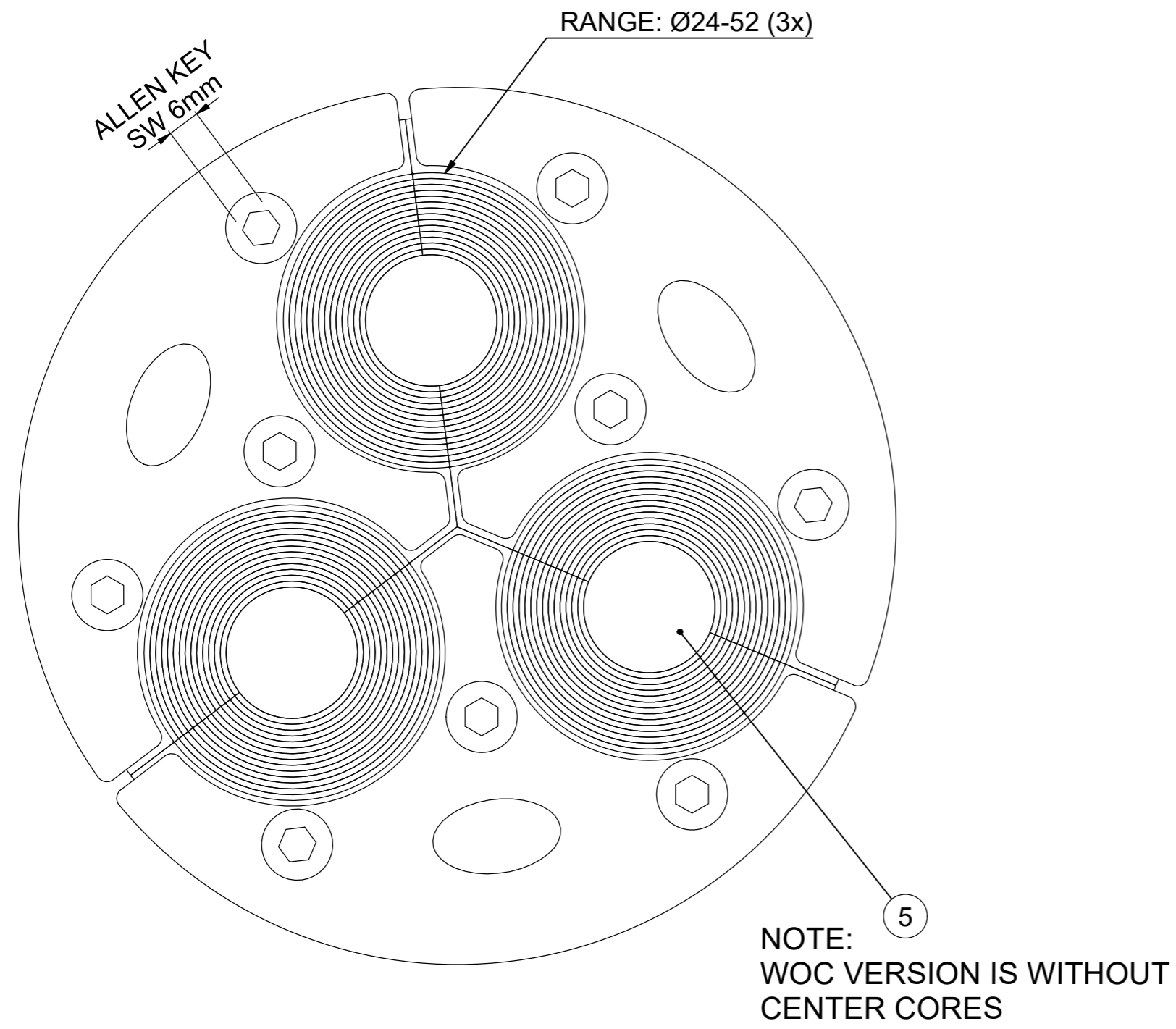

7	1	INSTALLATION INSTRUCTION							
6	1	LUBRICANT							
5	3	CENTER CORE	NOT IN WOC VERSIONS						
4	9	FASTENERS	M8 A4						0
3	3	FRONT FITTING	ACID PROOF STAINLESS STEEL						0.1
2	3	REAR FITTING	ACID PROOF STAINLESS STEEL						0.1
1	3	RUBBER FRAME	ROXYLON HE						
ITEM	QTY	Designation	Specification					Weight	
General tolerances used for manufacturing shown in document DOC-002180		Designed by/date se-danstr 2015-01-23	Latest save date 2018-06-26	Format A2	Scale	Sheet no 1 / 1	TotWeight 2.4 kg		
		Title H3-150 UG ASSEMBLY		Restricted due to Information drawing		Drawing number S1501351		Projection method Rev C	
www.roxtec.com									

C	MODEL ADJ.	2024-02-22	se-larlar
Rev	Type of revision	Date	Sign

Information drawings show general design and nominal dimensions if not else stated