

格克賽克保留所有权利。未经授权严禁复制、使用以及向第三方泄露。

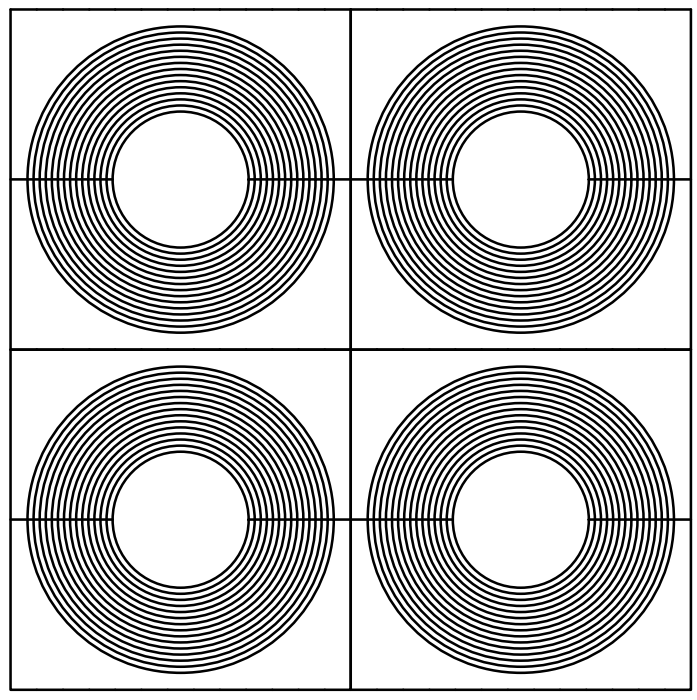
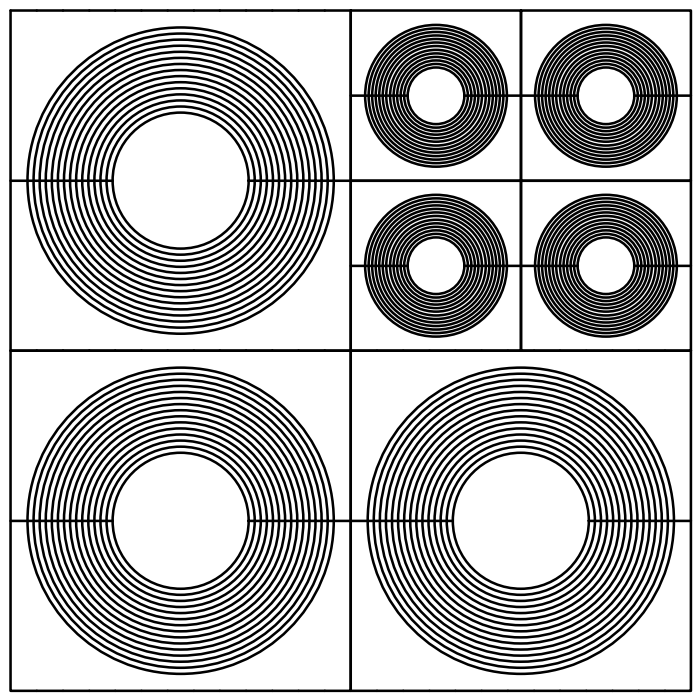
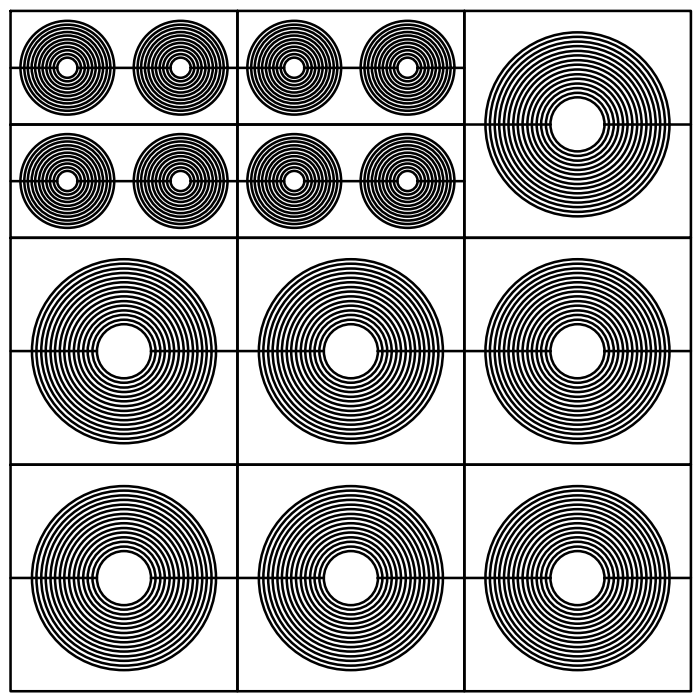
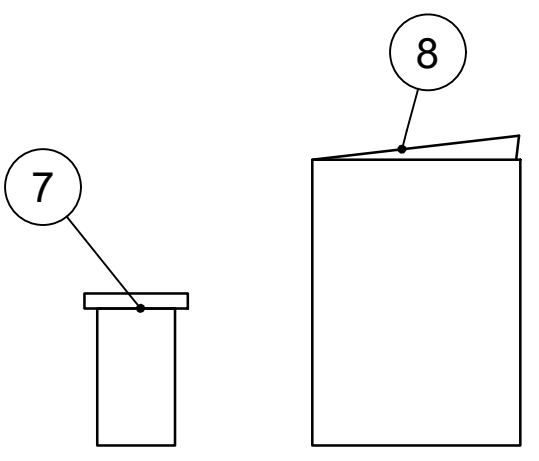
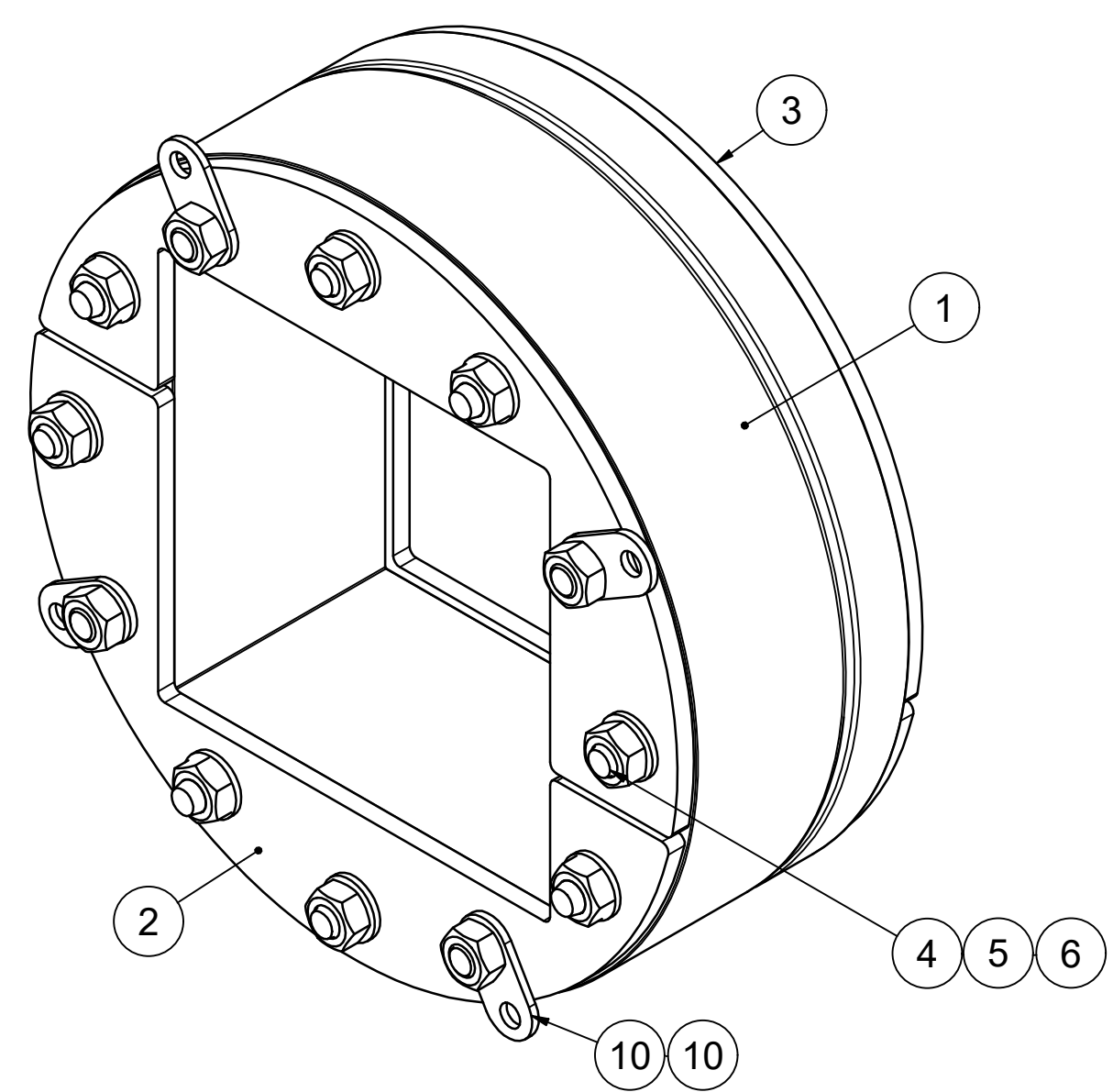
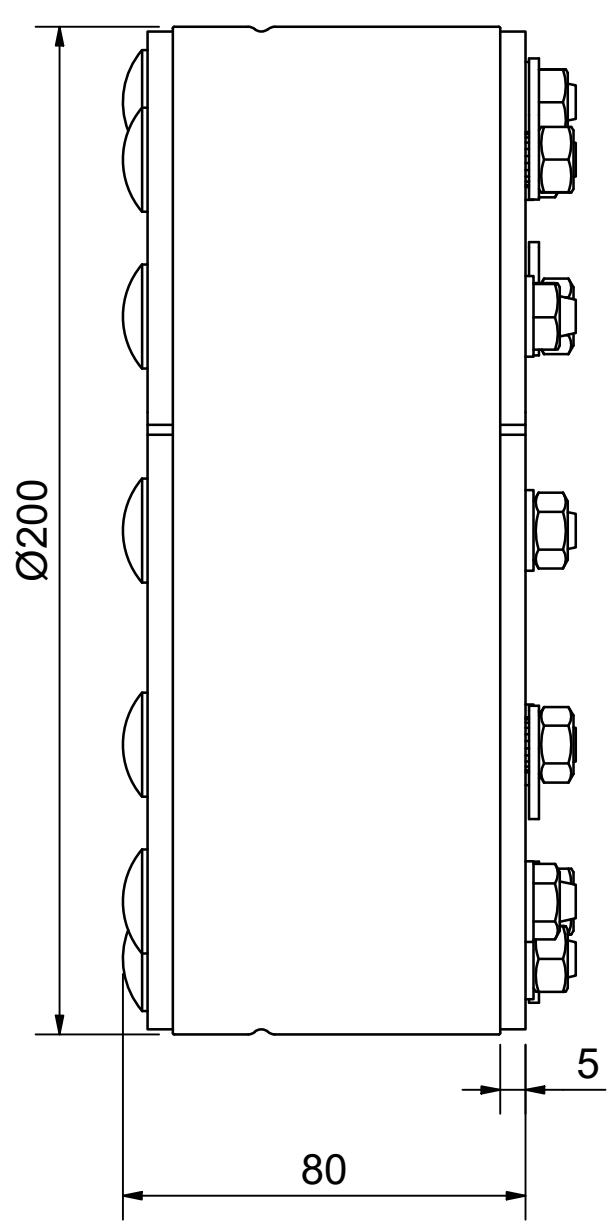
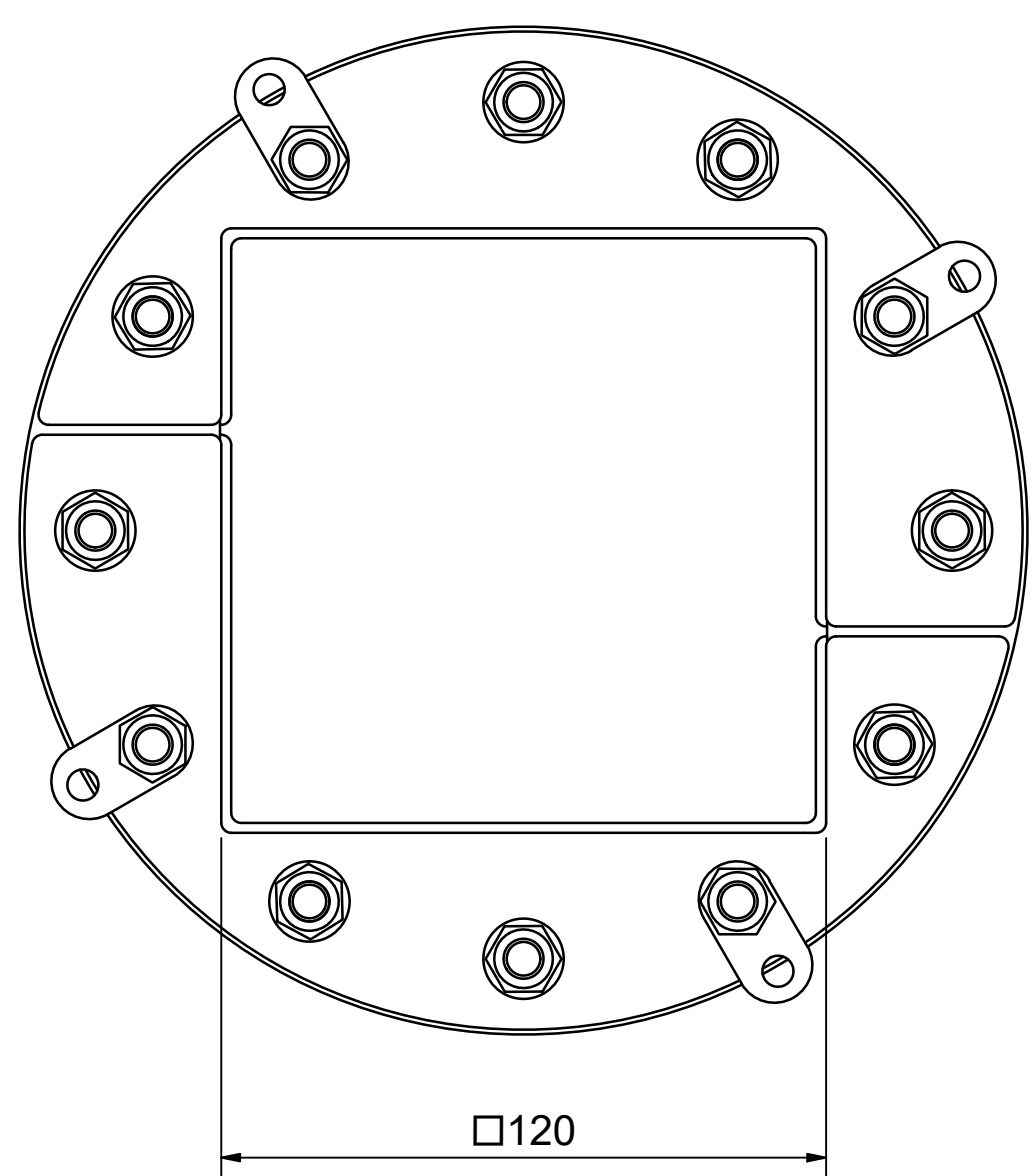

R 200/15 UG KIT		
MODULE	RANGE	QY.
RM 20W40 UG	0+4-13	4
RM 40 UG	0+9.5-31	7

R 200/7 UG KIT		
MODULE	RANGE	QTY.
RM 30 UG	0+10-23.5	4
RM 60 UG	0+24-52	3

R 200/4 UG KIT		
MODULE	RANGE	QTY
RM 60 UG	0+24-52 [0+0.94-2.05]	4

ITEM	QTY	Designation	Specification	Weight
10	4	STOP FLANGE	ACID PROOF STAINLESS STEEL	
9	4	LOCK WASHER	M8 A4	
8	1	INSTALLATION INSTRUCTION		
7	1	LUBRICANT	25ML	
6	12	NUT	M8 A4	
5	8	WASHER	M8 A4	
4	12	SCREW	MVBF M8x85 A4	
3	2	REAR FITTING	ACID PROOF STAINLESS STEEL	
2	2	FRONT FITTING	ACID PROOF STAINLESS STEEL	
1	1	RUBBER FRAME	ROXYLON	
ITEM QTY		Designation	Specification	Weight
General tolerances used for manufacturing shown in document (DCC-002180)		Designed by/date se-jenboh 2013-09-11	Latest save date	TotWeight 2.8 kg
Title R 200 UG KIT SOLUTIONS		Format A2	Scale	Sheet no 1 / 1
www.roxtec.com		Restricted due to Information drawing	Drawing number S1035392	Projection method Rev C

Rev	Type of revision	Date	Sign
C	DESIGN CHANGED	2020-11-02	se-jenboh

Information drawings show general design and nominal dimensions if not else stated

Rev 2.0 All rights reserved. Unauthorized reproduction, use or disclosure to third parties is strictly forbidden.