

PACKING SPACE FOR MODULES:
40x160 (1.575"x6.299") in two compartments

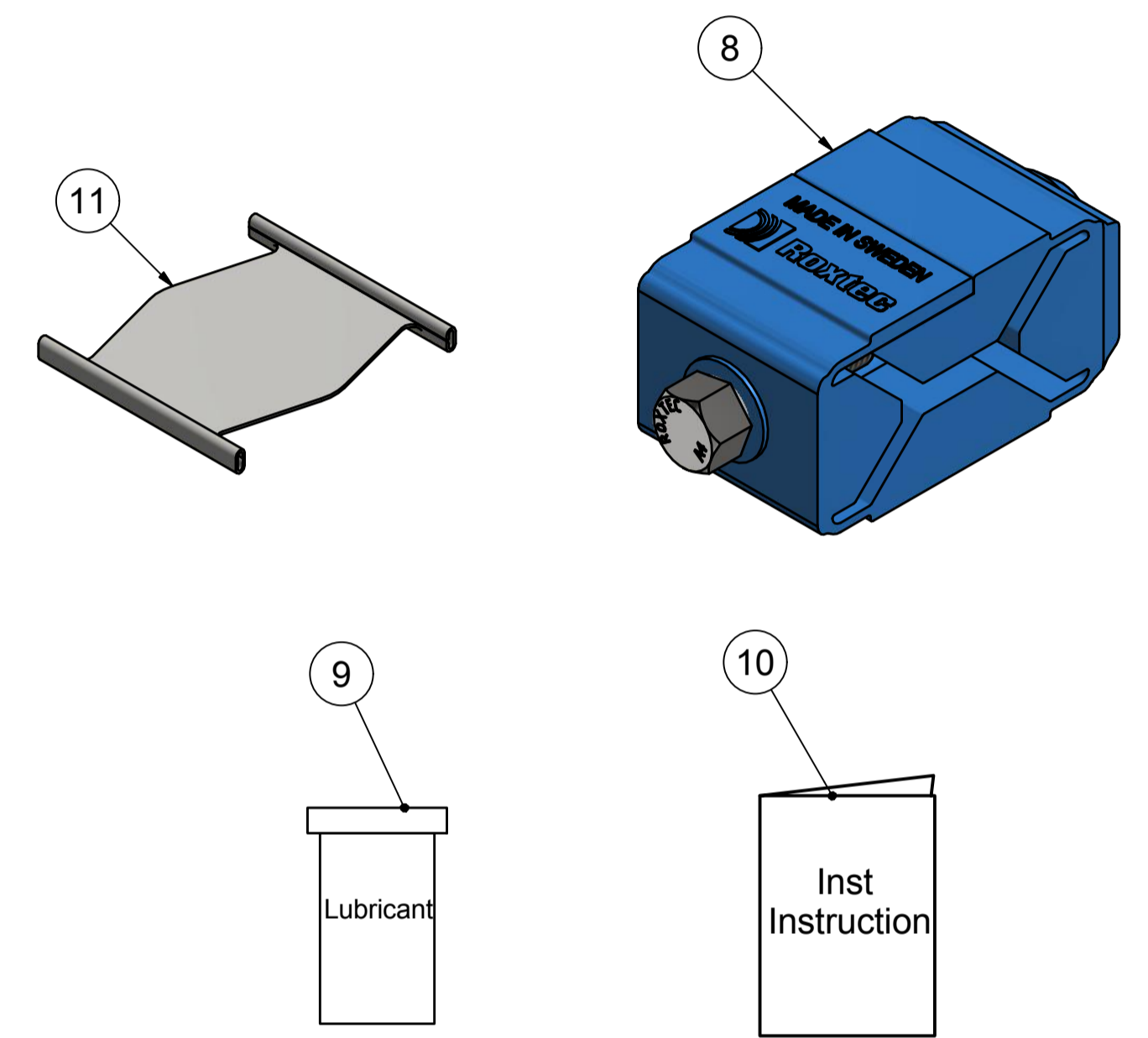
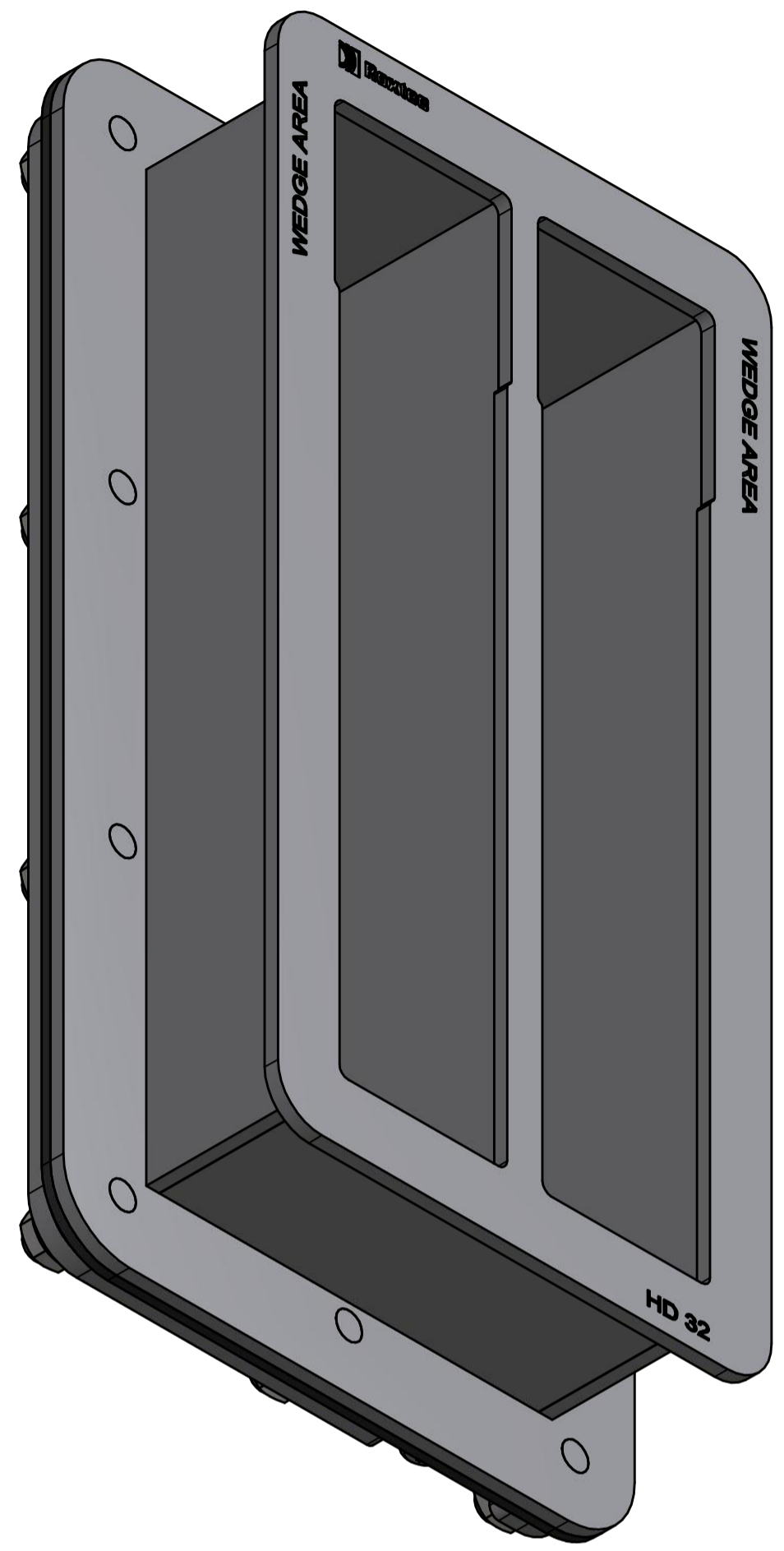

ITE	QTY	Designation	Specification	Weight
11	2	STAYPLATE 40 HD	ACID PROOF STAINLESS STEEL	
10	1	INSTALLATION INSTRUCTION		
9	1	LUBRICANT	25 ml	
8	2	C WEDGE HD AISI316		
7	10	FLANGED NUT	M6 SERRATED, A4	
6	1	SCREW	M5x10, A4	
5	1	SPRING WASHER	M5, A4	
4	1	SADDLE WASHER	ACID PROOF STAINLESS STEEL	
3	2	COUNTER FRAME	ACID PROOF STAINLESS STEEL	
2	1	GASKET	EPDM CELLULAR RUBBER	
1	1	HD 32 FRAME	ACID PROOF STAINLESS STEEL	

ITE	QTY	Designation	Specification	Weight
11	2	STAYPLATE 40 HD	ACID PROOF STAINLESS STEEL	
10	1	INSTALLATION INSTRUCTION		
9	1	LUBRICANT	25 ml	
8	2	C WEDGE HD AISI316		
7	10	FLANGED NUT	M6 SERRATED, A4	
6	1	SCREW	M5x10, A4	
5	1	SPRING WASHER	M5, A4	
4	1	SADDLE WASHER	ACID PROOF STAINLESS STEEL	
3	2	COUNTER FRAME	ACID PROOF STAINLESS STEEL	
2	1	GASKET	EPDM CELLULAR RUBBER	
1	1	HD 32 FRAME	ACID PROOF STAINLESS STEEL	

ITE	QTY	Designation	Specification	Weight
11	2	STAYPLATE 40 HD	ACID PROOF STAINLESS STEEL	
10	1	INSTALLATION INSTRUCTION		
9	1	LUBRICANT	25 ml	
8	2	C WEDGE HD AISI316		
7	10	FLANGED NUT	M6 SERRATED, A4	
6	1	SCREW	M5x10, A4	
5	1	SPRING WASHER	M5, A4	
4	1	SADDLE WASHER	ACID PROOF STAINLESS STEEL	
3	2	COUNTER FRAME	ACID PROOF STAINLESS STEEL	
2	1	GASKET	EPDM CELLULAR RUBBER	
1	1	HD 32 FRAME	ACID PROOF STAINLESS STEEL	

ITE	QTY	Designation	Specification	Weight
11	2	STAYPLATE 40 HD	ACID PROOF STAINLESS STEEL	
10	1	INSTALLATION INSTRUCTION		
9	1	LUBRICANT	25 ml	
8	2	C WEDGE HD AISI316		
7	10	FLANGED NUT	M6 SERRATED, A4	
6	1	SCREW	M5x10, A4	
5	1	SPRING WASHER	M5, A4	
4	1	SADDLE WASHER	ACID PROOF STAINLESS STEEL	
3	2	COUNTER FRAME	ACID PROOF STAINLESS STEEL	
2	1	GASKET	EPDM CELLULAR RUBBER	
1	1	HD 32 FRAME	ACID PROOF STAINLESS STEEL	

ITE	QTY	Designation	Specification	Weight
11	2	STAYPLATE 40 HD	ACID PROOF STAINLESS STEEL	
10	1	INSTALLATION INSTRUCTION		
9	1	LUBRICANT	25 ml	
8	2	C WEDGE HD AISI316		
7	10	FLANGED NUT	M6 SERRATED, A4	
6	1	SCREW	M5x10, A4	
5	1	SPRING WASHER	M5, A4	
4	1	SADDLE WASHER	ACID PROOF STAINLESS STEEL	
3	2	COUNTER FRAME	ACID PROOF STAINLESS STEEL	
2	1	GASKET	EPDM CELLULAR RUBBER	
1	1	HD 32 FRAME	ACID PROOF STAINLESS STEEL	

ITE	QTY	Designation	Specification	Weight
11	2	STAYPLATE 40 HD	ACID PROOF STAINLESS STEEL	
10	1	INSTALLATION INSTRUCTION		
9	1	LUBRICANT	25 ml	
8	2	C WEDGE HD AISI316		
7	10	FLANGED NUT	M6 SERRATED, A4	
6	1	SCREW	M5x10, A4	
5	1	SPRING WASHER	M5, A4	
4	1	SADDLE WASHER	ACID PROOF STAINLESS STEEL	
3	2	COUNTER FRAME	ACID PROOF STAINLESS STEEL	
2	1	GASKET	EPDM CELLULAR RUBBER	
1	1	HD 32 FRAME	ACID PROOF STAINLESS STEEL	

ITE	QTY	Designation	Specification	Weight
11	2	STAYPLATE 40 HD	ACID PROOF STAINLESS STEEL	
10	1	INSTALLATION INSTRUCTION		
9	1	LUBRICANT	25 ml	
8	2	C WEDGE HD AISI316		
7	10	FLANGED NUT	M6 SERRATED, A4	
6	1	SCREW	M5x10, A4	
5	1	SPRING WASHER	M5, A4	
4	1	SADDLE WASHER	ACID PROOF STAINLESS STEEL	
3	2	COUNTER FRAME	ACID PROOF STAINLESS STEEL	
2	1	GASKET	EPDM CELLULAR RUBBER	
1	1	HD 32 FRAME	ACID PROOF STAINLESS STEEL	

ITE	QTY	Designation	Specification	Weight
11	2	STAYPLATE 40 HD	ACID PROOF STAINLESS STEEL	
10	1	INSTALLATION INSTRUCTION		
9	1	LUBRICANT	25 ml	
8	2	C WEDGE HD AISI316		
7	10	FLANGED NUT	M6 SERRATED, A4	
6	1	SCREW	M5x10, A4	
5	1	SPRING WASHER	M5, A4	
4	1	SADDLE WASHER	ACID PROOF STAINLESS STEEL	
3	2	COUNTER FRAME	ACID PROOF STAINLESS STEEL	
2	1	GASKET	EPDM CELLULAR RUBBER	
1	1	HD 32 FRAME	ACID PROOF STAINLESS STEEL	

All rights reserved. Unauthorised reproduction, use or disclosure to third parties is strictly forbidden. 格克賽克保留所有權利。未經授權嚴禁复制或向第三方洩漏。

Rev	Type of revision	Date	Sign
C		2016-05-31	se-danstr

Roxtec
 HD32
 FRAME ASSEMBLY
 Restricted due to Information drawing
 Drawing number: S1032869
 Rev: C