

烙克塞克保留所有权利。未经授权严禁复制，使用以及向第三方泄露。

All rights reserved. Unauthorized reproduction, use or disclosure to third parties is strictly forbidden.

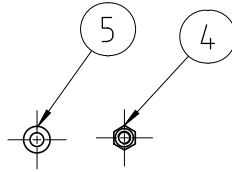
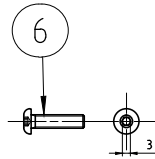
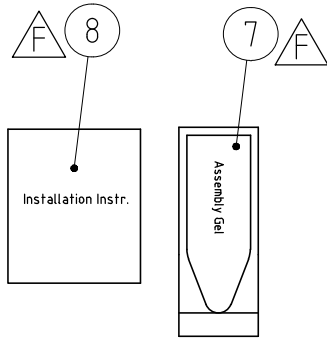
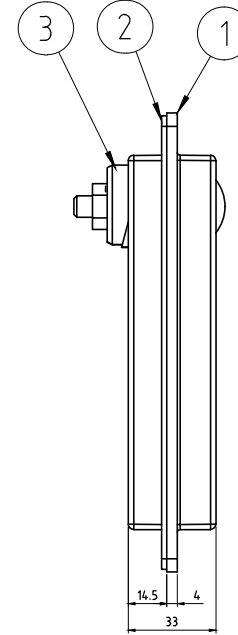
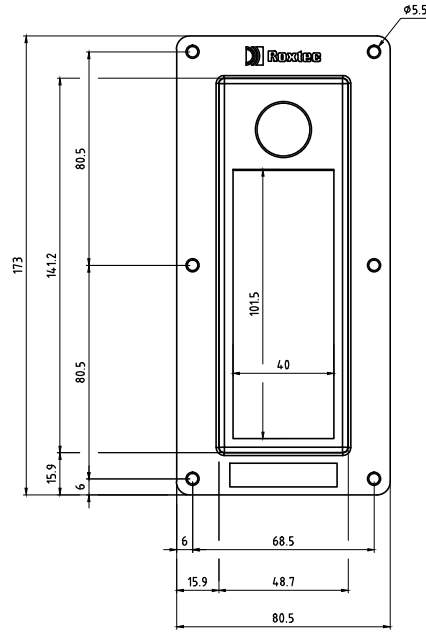
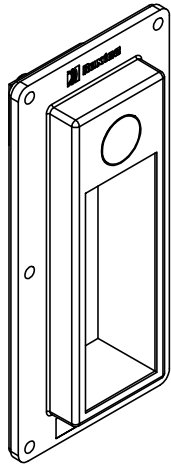

Item	Qty	Designation	Specification	Net Weight
8	1	INSTALLATION INSTR.		
7	1	ASSEMBLY GEL	10 ML	
6	6	SCREW	K6S M5x20 A4-70 NYSEAL	
5	6	WASHER	M5 A4 140HV DIN125	
4	6	NUT	M6M M5 A4-70 ISO4032	
3	1	COMPRESSION UNIT	RUBBER/ AISI 316	
2	1	GASKET	EPDM CELLUAR RUBBER	
1	1	FRAME	COMSEAL 10	

Item	Qty	Designation	Specification	Net Weight															
General Tolerance		Welded details		General surface		Designed by		Created Date		Latest save date		Format		Scale		Sheet no		TotWeight	
ISO 2768-1/2-m/K		EN ISO 5817-B		Ra 12.5		se-milkar		2008-01-31		2015-03-20		A3		1:2				-	
EN ISO 13920-BF		EN ISO 10042-B				Title												Projection method	
						COMSEAL 10												ASSEMBLY	
						Restricted due to												Information	
																		Drawing number	
																		S1013111	
																		Rev	
																		F	

Rev	Type of revision	Date	Sign
F	LUBRICANT AND INST. INSTR. ADDED.	2015-03-19	se-almbah

