

We reserve all rights in this document and in the information contained therein. Reproduction, use or disclosure to third parties without express authority is strictly forbidden. ©ROXTEC INTERNATIONAL AB

TYPE	Di	Do	L
SLRS-23	23,5	32	35
SLRS-25	25,5	34	35
SLRS-31	31,5	40	35
SLRS-43	44	52	65
SLRS-50	51	63	65
SLRS-68	69,5	83	65
SLRS-75	76,5	89	65
SLRS-100	101	114	65
SLRS-125	126	140	65
SLRS-150	151	164	65

MATERIAL AND SURFACE TREATMENT				
SHARP EDGES BROKEN				
-	ST 35	S235G2T	-	-
-	ST 52-3N	S355J2G3	-	-
2	PRIMED, BLACK ACC. TO S1005244			
E	SS 2353	X2CrNiMo18-14-3	1.4435	AISI 316L

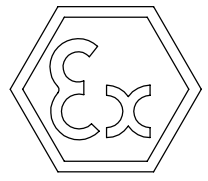
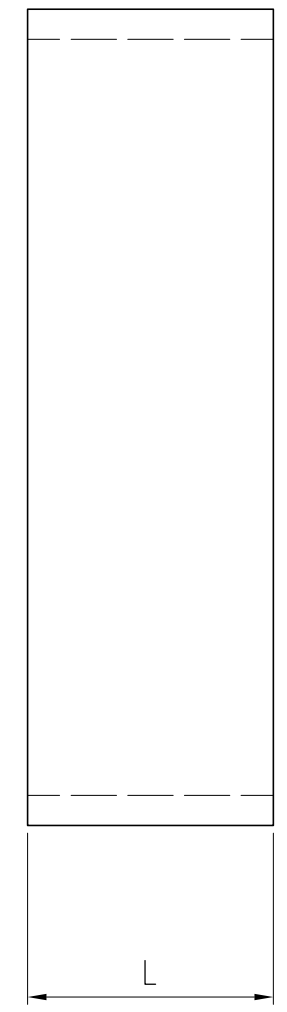
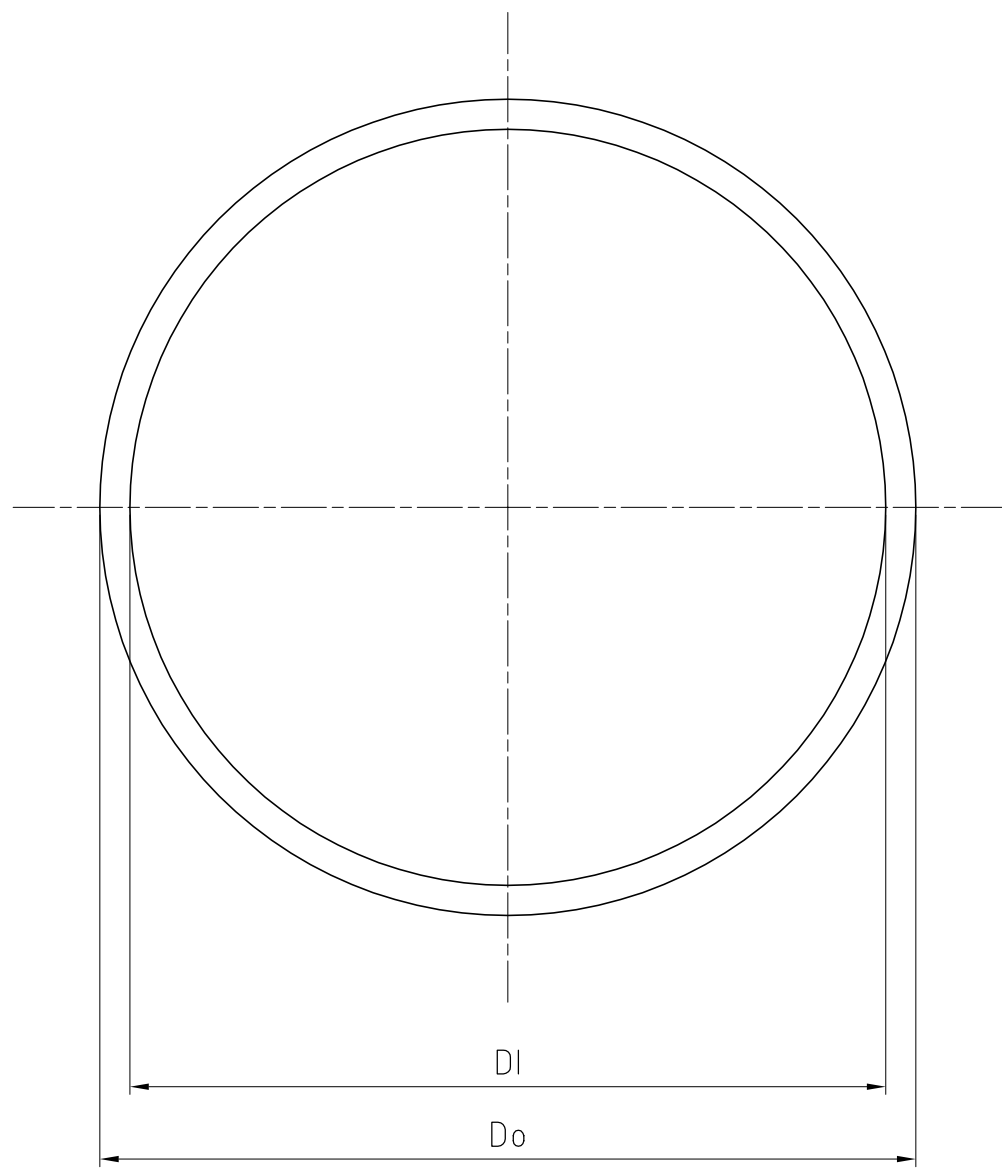

Rev	Type of revision	Date	Sign
-	-		

Item	Qty	Designation	Specification				Net Weight
ROXTEC INTERNATIONAL AB BOX 540 S-371 23 Karlskrona TEL: +46 455 366700 FAX: +46 455 82012		AN KARLSSON Checked by JE BOHLIN Approved by JE BOHLIN	Date 2006-01-18 Format A3 Scale 1:2	General tolerance ISO 2768-1 m	Welded details SS-EN 25 817 SS-EN 30 042 -	General surface roughness, Ra -	TotWeight -
		Restricted due to INFORMATION DRAWING	Title SLRS EX SLRS 23 - SLRS 150	Drawing number S1008813		Projection method	Rev -