

| TYPE | Di (mm) | Do (mm) | A° | Ø mm | N (x) | T (mm) |
|----------|---------|---------|----|------|-------|--------|
| SLFR 70 | 84 | 160 | 90 | 130 | 4 | 4 |
| SLFR 75 | 90 | 165 | 90 | 135 | 4 | 4 |
| SLFR 100 | 115 | 195 | 60 | 165 | 6 | 4 |
| SLFR 125 | 141 | 213 | 60 | 183 | 6 | 4 |
| SLFR 127 | 141 | 213 | 60 | 183 | 6 | 4 |
| SLFR 150 | 165 | 236 | 60 | 206 | 6 | 4 |
| SLFR 200 | 215 | 290 | 45 | 260 | 8 | 4 |

| MATERIAL AND SURFACE TREATMENT | | | | |
|--------------------------------|-----------------------------------|-----------------|--------|-----------|
| SHARP EDGES BROKEN | | | | |
| - | ST 35 | S235G2T | - | - |
| - | ST 52-3N | S355J2G3 | - | - |
| 2 | PRIMED, BLACK ACC. TO S1005244 | | | |
| F | SS 4212 | EN AW-6082 | 3.2315 | AA 6082 |
| E | SS 2353 | X2CrNiMo18-14-3 | 1.4435 | AISI 316L |

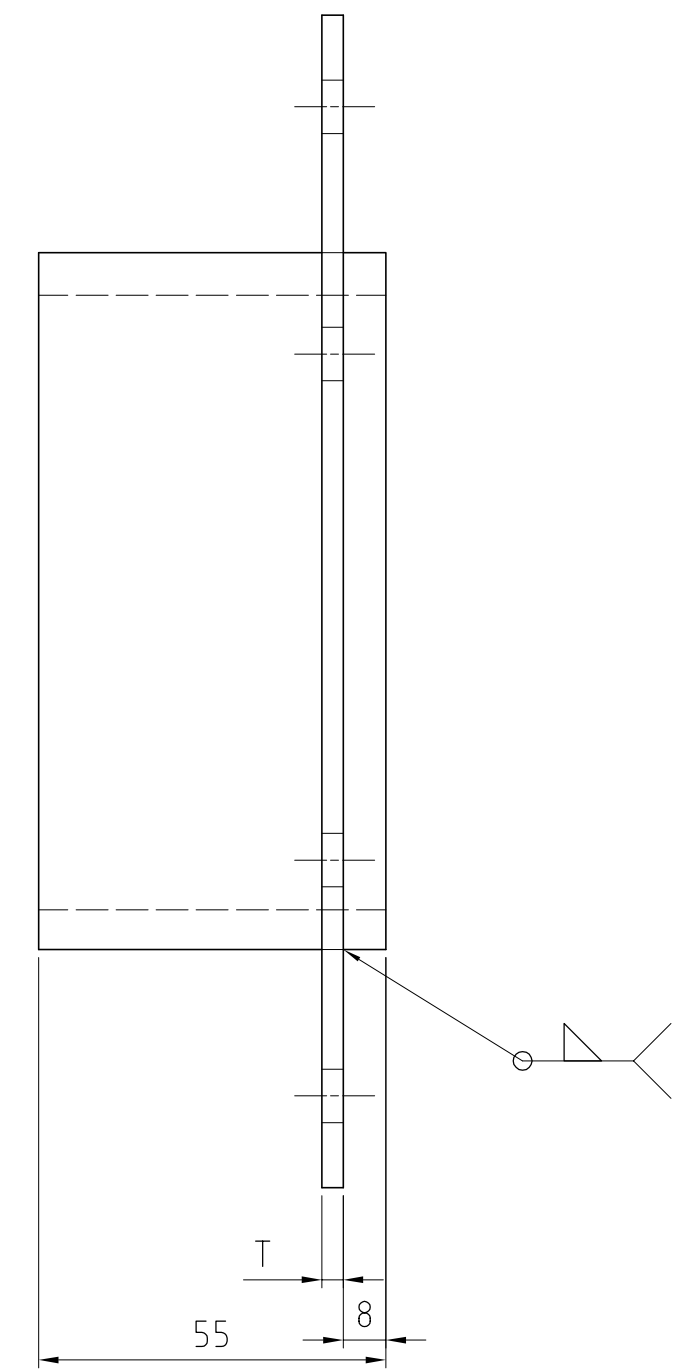

We reserve all rights in this document and in the information contained therein. Reproduction, use or disclosure to third parties without express authority is strictly forbidden. ROXTEC INTERNATIONAL AB

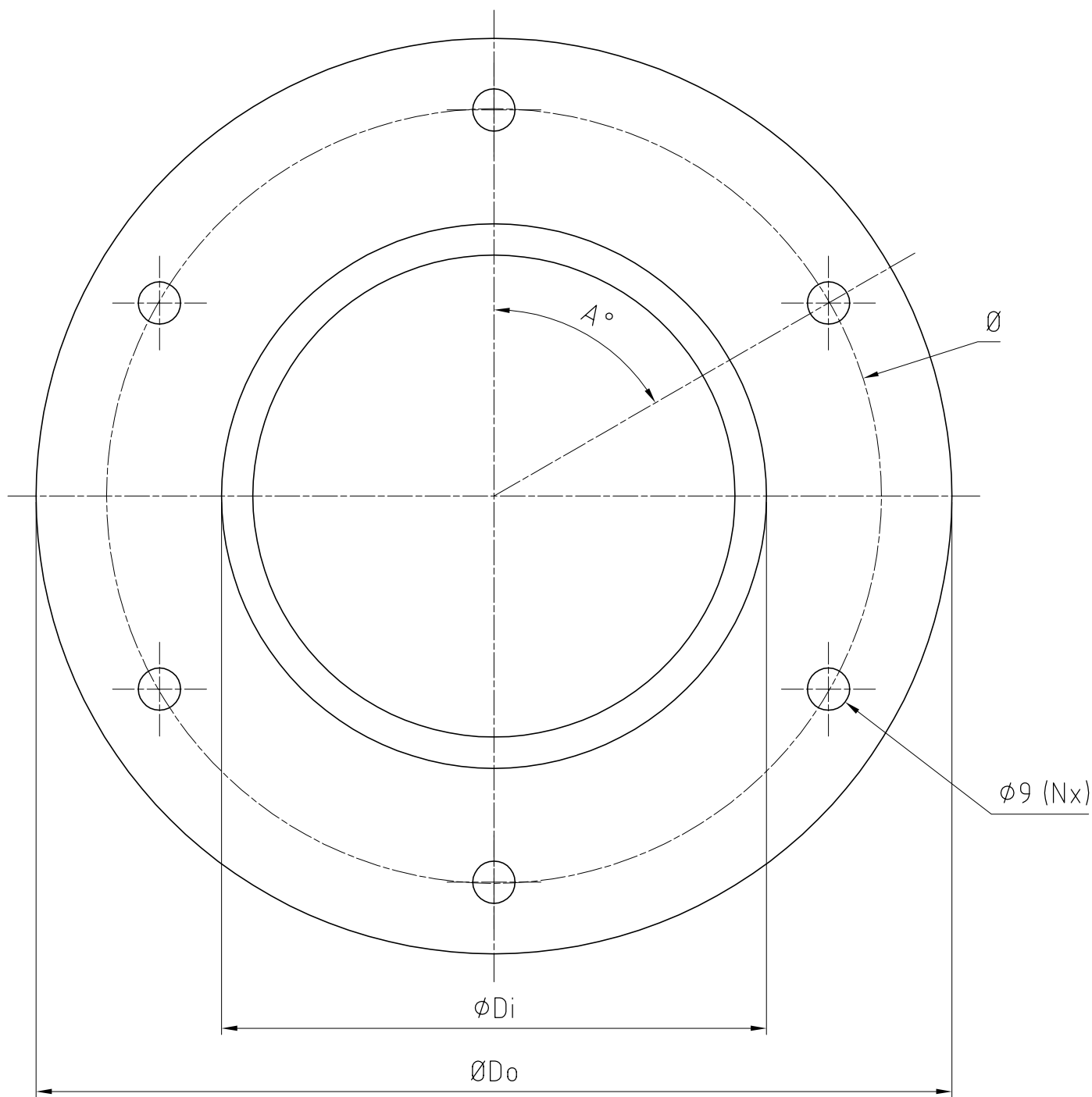
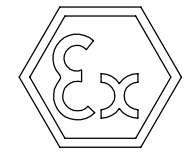

| Rev | Type of revision | Date | Sign |
|-----|------------------|------|------|
| - | - | | |

| Item | Qty | Designation | Specification | NetWeight | |
|--|-----|--|--|---|-------------------|
| ROXTEC INTERNATIONAL AB BOX 540 S-371 23 Karlskrona TEL: +46 455 366700 FAX: +46 455 82012 | | Designed by AN KARLSSON Checked by JE BOHLIN Approved by JE BOHLIN | Date 2005-11-14 Format A3 Scale - | General tolerance ISO 2768-1 m Welded details SS-EN 50 042 - General surface roughness, Ra - | Total Weight - |
| | | Title SLFR EX FOR R 70 - R 200 | | Projection method | |
| Restricted due to INFORMATION DRAWING | | | Drawing number S1008612 | Rev - | |