

洛克赛克保留所有权利。未经授权，严禁复制或向第三方泄露。

All rights reserved. Unauthorized reproduction, use or disclosure to third parties is strictly forbidden.

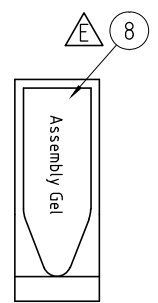
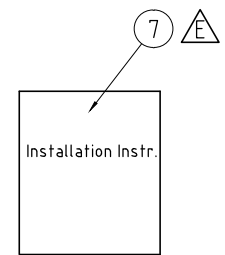
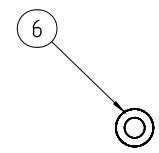
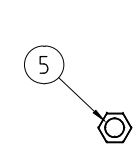
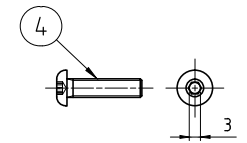
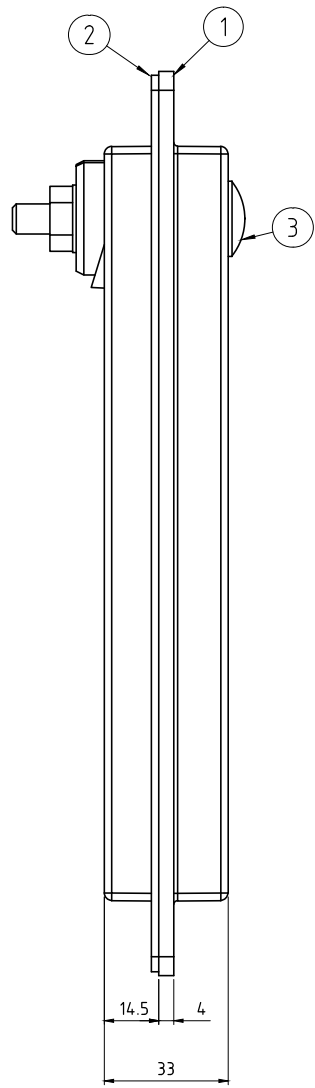
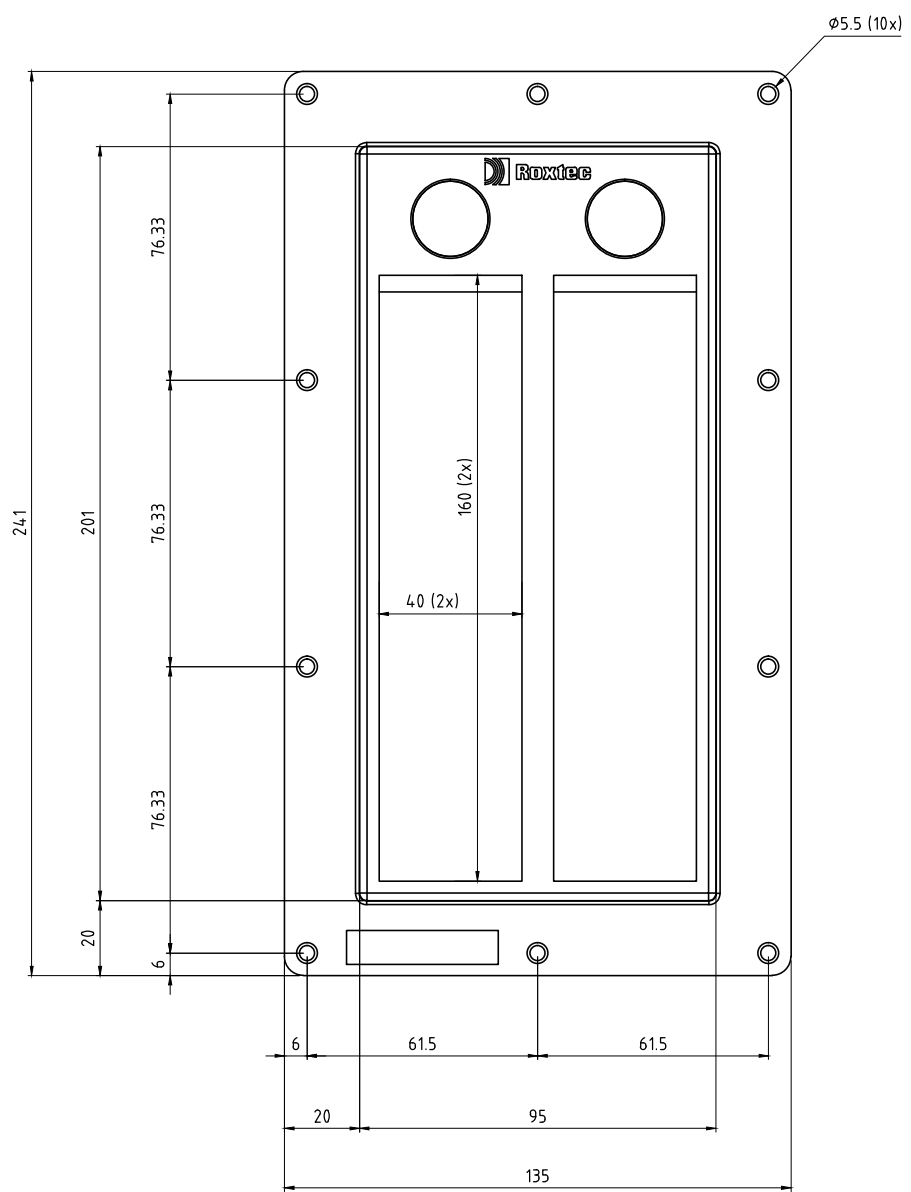

Item	Qty	Designation	Specification	Net Weight
8	1	INSTALLATION INSTRUCTION		-
7	1	ASSEMBLY GEL		-
6	10	WASHER	M5 A4 14.0HV DIN 125	-
5	10	NUT	M6M M5 A4-70 ISO 4032	-
4	10	SCREW	K6S M5x20 A4-70 NYSEAL	-
3	2	COMPRESSION UNIT	RUBBER/AISI 316	-
2	-	GASKET	CELLULAR RUBBER	-
1	-	FRAME	ALU. POWDER COATED RAL 7035	-

General Reference	Material details	General surface treatment	Design by	Created Date	Direct save date	Format	Scale	Sheet no	Total weight
ISO 10161-1/2 EN ISO 1992-01	EN ISO 5817-05 EN ISO 10142-0	EN ISO 10142-0 12.3	se-arnkar	2005-09-09	2015-03-20	A2	1:1		-
			COMSEAL 32 ASSEMBLY		Restricted due to Information		Drawing number S1008289		Projection method
Rev	Type of revision	Date	Sign					Rev	E

E	ASSEMBLY GEL AND INST INSTR ADDED.	2015-03-20	se-tonfor
Rev	Type of revision	Date	Sign