

洛克赛克保留所有权利。未经授权，严禁复制或向第三方泄露。

All rights reserved. Unauthorized reproduction, use or disclosure to third parties is strictly forbidden.

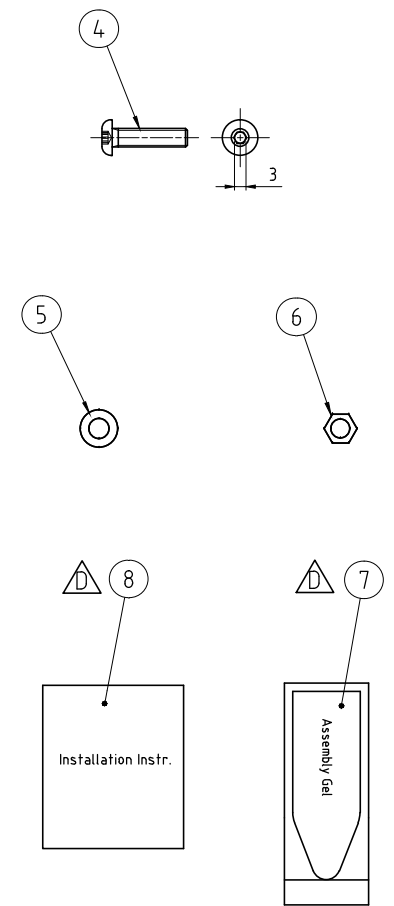
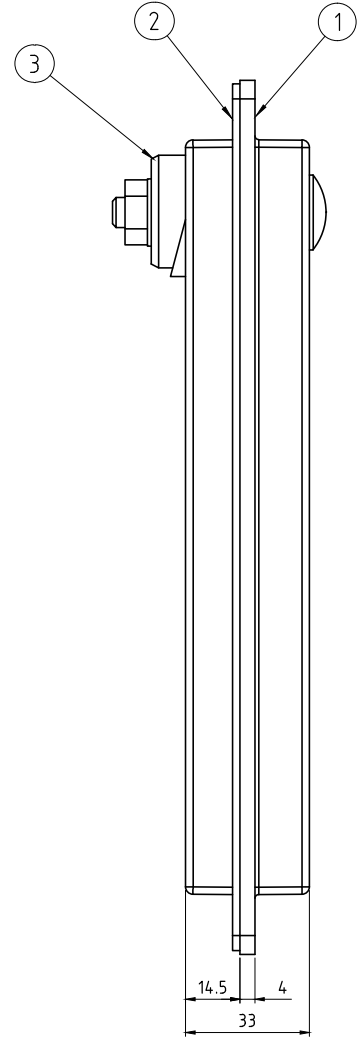
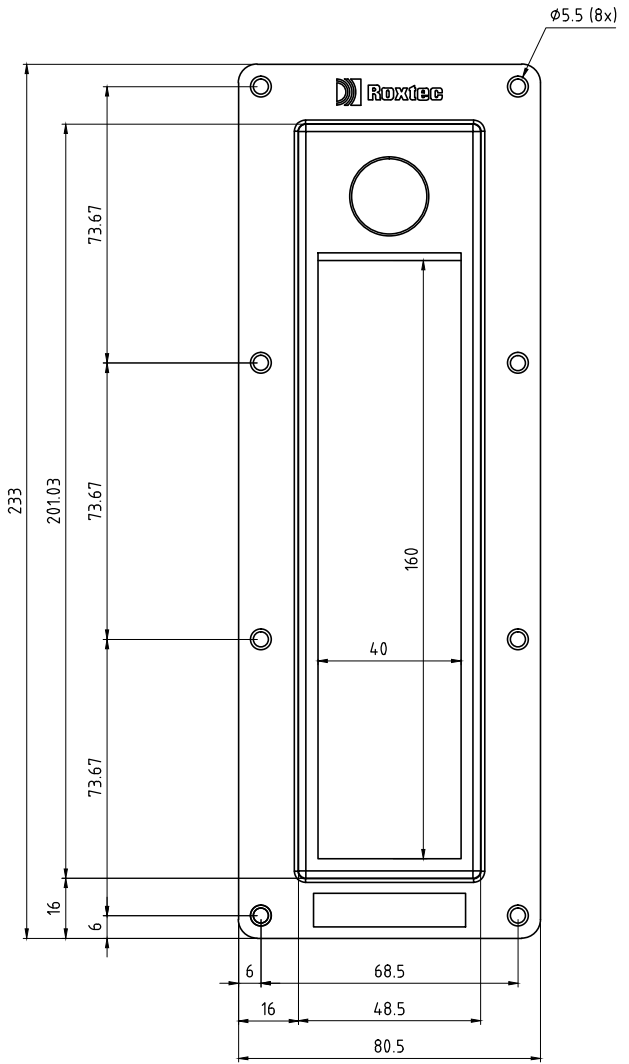

Item	Qty	Designation	Specification	Net Weight
8	1	INSTALLATION INSTRUCTION		
7	1	ASSEMBLY GEL	10 ML	
6	8	NUT	M6M M5 A4-70 ISO 4032	
5	8	WASHER	M5 A4 140HV DIN 125	
4	8	SCREW	K6S M5x20 A4-70 NYSEAL	
3	1	COMPRESSION UNIT	RUBBER/AISI 316	
2	1	GASKET	CELLULAR RUBBER	
1	1	FRAME	ALU POWDER COATED RAL 7035	

General Reference	Material details	General surface treatment	Designed by	Created Date	Project name date	Format	Scale	Sheet no	Total weight
ISO 10161-1/2 EN ISO 19901-01	EN ISO 19917-01 EN ISO 10142-0	12.3	se-arnkar	2005-09-09	2015-03-23	A2	1:1		-
Title			COMSEAL 16 ASSEMBLY						
www.roxtec.com			Restricted due to Information				Drawing number		S1008288
Rev									D

Rev	Type of revision	Date	Sign
D	ASSEMBLY GEL AND INST INSTR ADDED.	2015-03-22	se-almBah