

烙克賽克保留所有权利。未经授权严禁复制，使用以及向第三方泄漏。

All rights reserved. Unauthorized reproduction, use or disclosure to third parties is strictly forbidden.

Rev 3.1

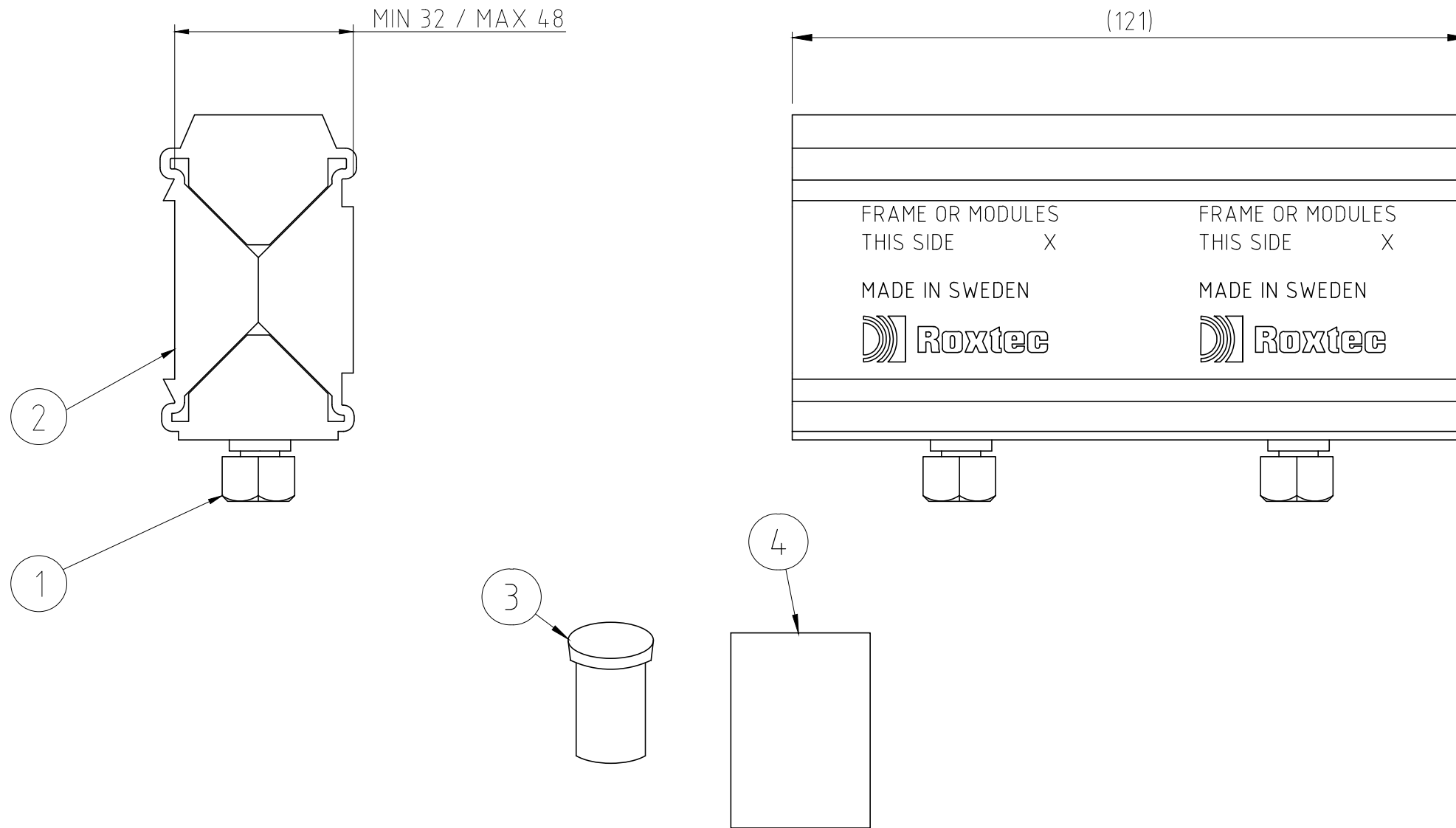

4	1	INSTALLATION INSTRUCTION								-
3	1	LUBRICANT								-
2	1	RUBBER			ROXYLON					-
1	2	SCREW			AIS316/ GALV					-
Item	Qty	Designation	Specification							Net Weight
General tolerances used for manufacturing shown in document DOC-002180		Designed by	Created Date	Latest save date	Format	Scale	Sheet no	Tot Weight		
		se-stemil	2004-07-23	2024-07-04	A3	1:1		-		
		Title		Projection method						
		C WEDGE 120								
		ASSEMBLY		Restricted due to		Drawing number		Rev		
		www.roxtec.com		Information drawing		S1006467		A		

A	LUBRICANT ADDED	2024-01-03	se-larlar
Rev	Type of revision	Date	Sign

Information drawings show general design and nominal dimensions if not else stated