

Installation instructions
Roxtec CSP with Roxtec HD modules

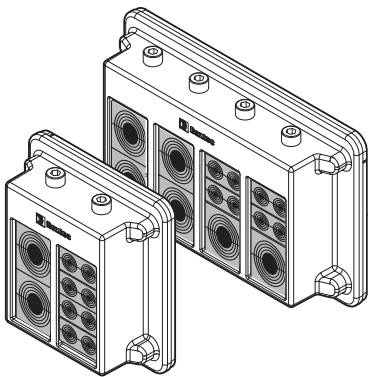

Components

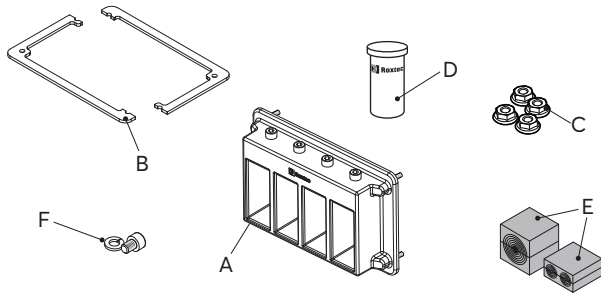

- A. Roxtec CSP frame
- B. Roxtec CSP counter frame
- C. Fasteners
- D. Roxtec Lubricant
- E. Roxtec HD modules
- F. Fasteners for protective bonding conductor

Additional information

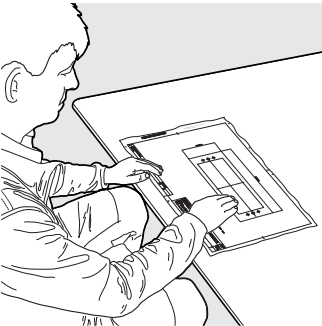

Additional information is available, such as drawings, apertures, videos, ratings and certificates.



Scan QR code or visit [roxtec.com](https://www.roxtec.com) for additional information.

Technical data

| Name | External dimensions WxHxD (mm) | For cable/pipe Ø (mm) |
|-------------|--------------------------------|-----------------------|
| HD 15w40 | 40 x 15 x 40 | 3.5 – 9.5 |
| HD 20w40 | 40 x 20 x 40 | 3.5 – 15.5 |
| HD 30w40 | 40 x 30 x 40 | 10 – 24 |
| HD 40 | 40 x 40 x 40 | 21.5 – 33.5 |
| HD 40 10–32 | 40 x 40 x 40 | 9.5 – 31.5 |

Tools

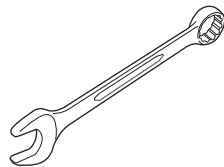

Spanner 10 mm (not included)

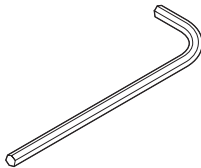

Allen key 5 mm (not included)

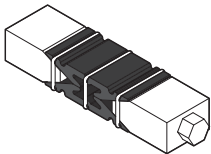

Roxtec pre-compression wedge 40/60 (not included)

Disassembly and reinstallation

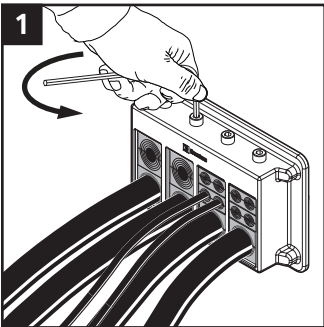

Untighten the screw of the compression unit.

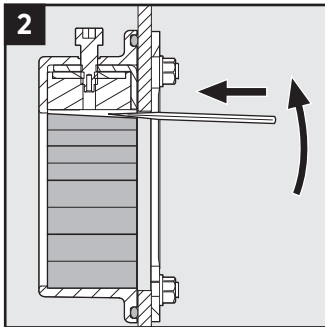

Use a flat tool to simplify removal of the modules.

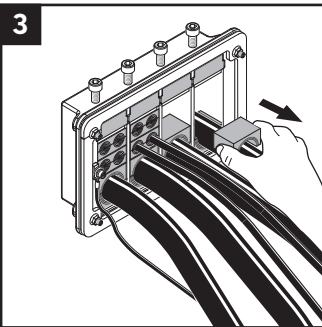

Remove the modules needed.

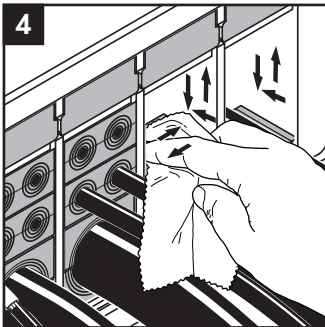

Clean the exposed surfaces.

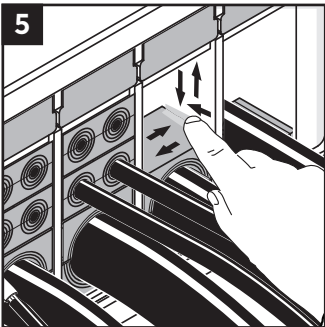

Lubricate the exposed surfaces, especially in the corners. Continue the reinstallation.

Installation

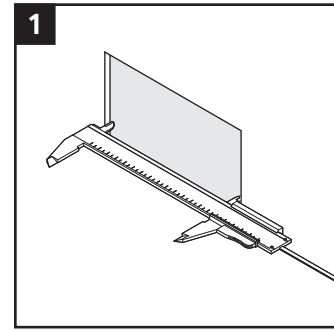

Make or verify an aperture.

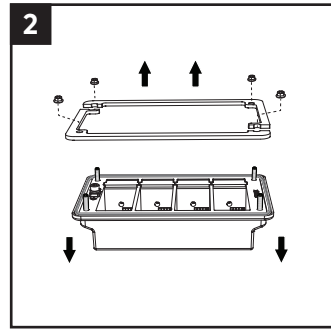

Remove nuts and counter frames.

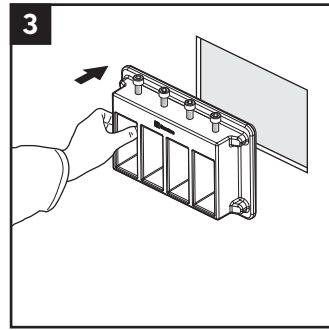

Place the frame onto the structure.

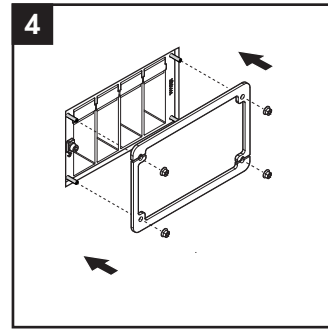

Mount the counter frames and nuts.

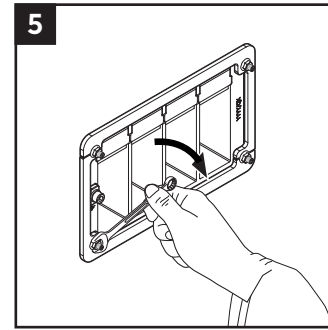

Tighten the nuts crosswise in small steps. Recommended torque 7 Nm.

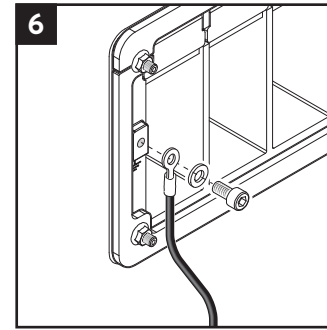

Attach the protective bonding conductor to the earthing terminal. National regulations apply.

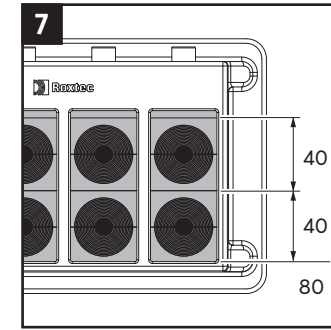

The combined height of modules shall be 80 mm.

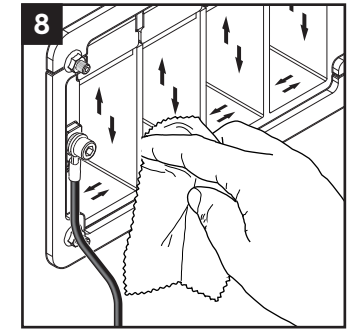

Clean the inside surfaces of the frame.

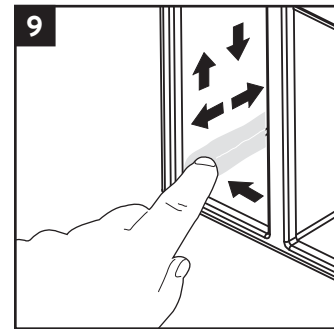

Lubricate the sealing surfaces of the frame, especially in the corners.

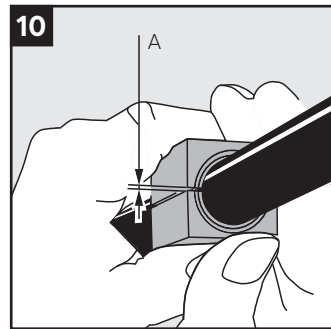

Achieve a 0.1-1.0 mm (A) gap between the two module halves when held against the cable/pipe.

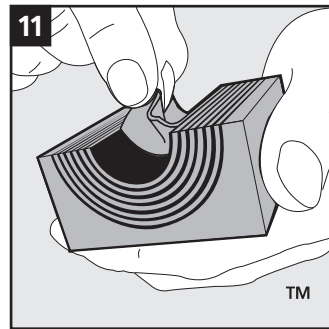

Adapt the modules by peeling off layers.

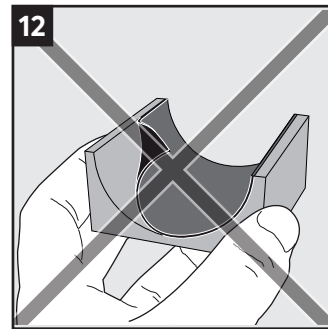

Do not remove the last layer.

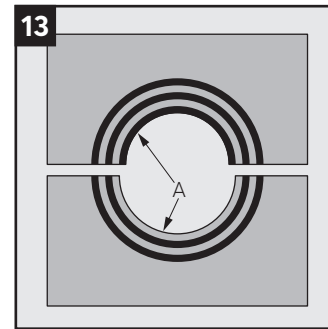

The number of layers may not differ (A) by more than one between the corresponding module halves.

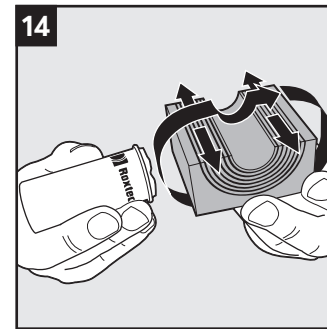

Lubricate the sealing surfaces with Roxtec Lubricant.

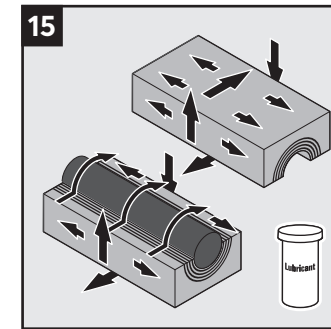

Lubricate the sealing surfaces of any spare module. Do not remove the core.

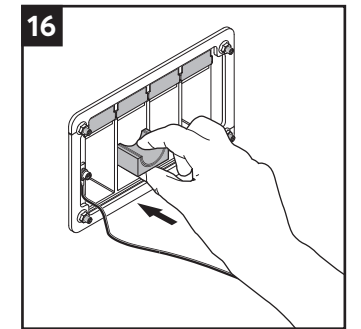

Insert the modules from the back side of the transit according to the packing plan.

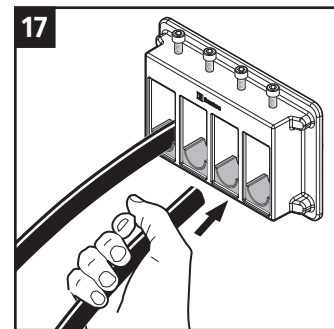

Insert cables/pipes straight through the frame.

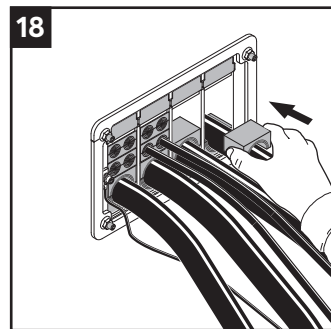

Place the corresponding module halves on top. Continue to fill the transit considering your packing plan.

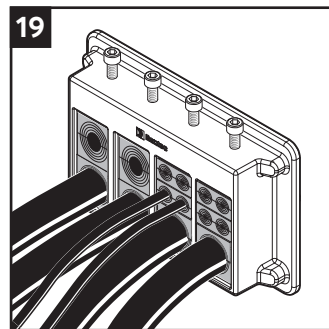

All packing spaces shall be filled before the compression screws are tightened.

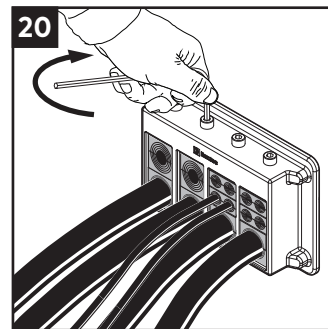

Tighten the screws alternately in small steps until full stop, approx. 20 Nm. Protruding excess lubricant indicates a tight seal.



Check additional documentation, if applicable.

After installation inspection

- Are the compression screws fully tightened?
- Is the combined height of modules correct according to the frame packing height?
- Are all modules placed correctly and fully inserted after compression?
- Is there visible protruding lubricant?

Note

- For optimum reliability, wait 24 hours or longer after installation before exposing the cables/pipes to strain or pressure.
- An incorrectly adapted module shall be replaced (layers shall not be reused).
- Cable/pipe with a considerable weight needs to be supported to prevent damage or subsidence to the seal.
- Cores or cables/pipes must be present in all modules.
- To be used with: Roxtec HD components.
- Cables/pipes shall go straight through the frame.
- Partially installed openings shall be compressed if left unattended.
- The latest version of this and related documents are found at roxtec.com.
- Approvals or certificates may include amendments or limitations related to this application.

Disclaimer

"The Roxtec cable and pipe entry sealing system ('the Roxtec system') is a modular-based system of sealing products consisting of different components. Each and every one of the components is necessary for the best performance of the Roxtec system. The Roxtec system has been certified to resist a number of different hazards. Any such certification, and the ability of the Roxtec system to resist such hazards, is dependent on all components that are installed as a part of the Roxtec system. Thus, the certification is not valid and does not apply unless all components installed as part of the Roxtec system are manufactured by or under license from Roxtec ('authorized manufacturer'). Roxtec gives no performance guarantee with respect to the Roxtec system, unless (I) all components installed as part of the Roxtec system are manufactured by an authorized manufacturer and (II) the purchaser is in compliance with (a), and (b), below.

(a) During storage, the Roxtec system or part thereof, shall be kept indoors in its original packaging at room temperature.

(b) Installation shall be carried out in accordance with Roxtec installation instructions in effect from time to time.

The product information provided by Roxtec does not release the purchaser of the Roxtec system, or part thereof, from the obligation to independently

determine the suitability of the products for the intended process, installation and/or use.

Roxtec gives no guarantee for the Roxtec system or any part thereof and assumes no liability for any loss or damage whatsoever, whether direct, indirect, consequential, loss of profit or otherwise, occurred or caused by the Roxtec systems or installations containing components not manufactured by an authorized manufacturer and/or occurred or caused by the use of the Roxtec system in a manner or for an application other than for which the Roxtec system was designed or intended.

Roxtec expressly excludes any implied warranties of merchantability and fitness for a particular purpose and all other express or implied representations and warranties provided by statute or common law. User determines suitability of the Roxtec system for intended use and assumes all risk and liability in connection therewith. In no event shall Roxtec be liable for indirect, consequential, punitive, special, exemplary or incidental damages or losses.

The Roxtec products are offered and sold in accordance with the conditions of the Roxtec General Terms of Sales. The latest version of the Roxtec General Terms of Sales can be found and downloaded from roxtec.com/general-terms-of-sales.



Roxtec International AB
Box 540, 371 23 Karlskrona, SWEDEN
+46 455 36 67 00, info@roxtec.com
www.roxtec.com