

Installation instructions

Roxtec SPM™ seal

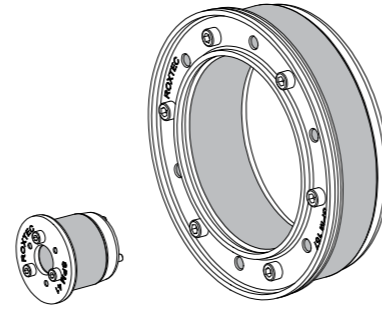

Safety information

Roxtec recommends that all installations are performed without facility operation. Follow national regulations and installation codes. Any action affecting the routed service should be performed according to manufacturer recommendations.

Aperture

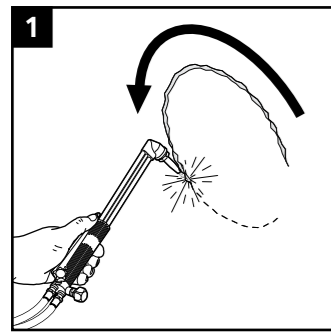

1 Make an aperture according to the table.

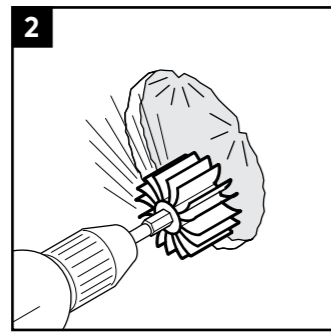

2 Remove all sharp edges to avoid damage to the rubber of the seal.

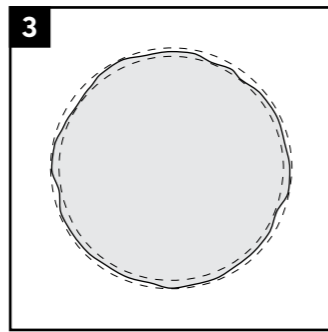

3 Irregularities are acceptable only within the aperture tolerance.

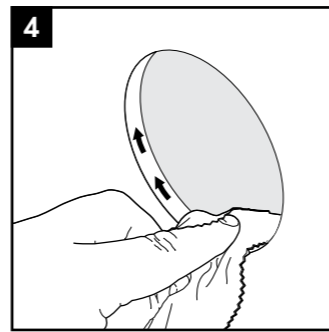

4 Make sure the aperture is free from dirt and dust.

Tools

- Allen key (not included)

Technical data

Thickness of the structure must be between 5 mm and 15 mm.

Name	Aperture dimension Ø (mm)	For cable/pipe Ø (mm)	Torque (Nm)	Tool size (mm)
SPM 39	39 – 43	8 – 12	~2	3
SPM 41	41 – 45	12 – 16	~2	3
SPM 48	48 – 52	16 – 20	~2	3
SPM 54	53.5 – 57.5	19 – 23	~2	3
SPM 59	58.5 – 62.5	24 – 28	~3	4
SPM 62	61.5 – 65.5	27 – 31	~3	4
SPM 69	68.5 – 72.5	32 – 36	~3	4
SPM 77	77 – 81	37 – 42	~3	4
SPM 81	81 – 85	41.4 – 45.4	~3	4
SPM 87	87 – 91	47 – 51	~3	4
SPM 92	92 – 96	52 – 56	~3	4
SPM 103	103 – 107	56.2 – 61.1	~7	5
SPM 110	110 – 114	65 – 69	~7	5
SPM 119	119 – 123	72.2 – 76.9	~7	5
SPM 125	125 – 129	77 – 81	~7	5
SPM 138	138 – 142	88 – 92	~7	5
SPM 149	149 – 153	99 – 103	~7	5
SPM 153	153 – 157	103 – 107	~7	5
SPM 157	157 – 161	107 – 111	~7	5
SPM 168	168 – 172	113 – 117	~10	6
SPM 178	178 – 182	123 – 127	~10	6
SPM 188	188 – 192	131 – 135	~10	6
SPM 196	196 – 200	138.5 – 143	~10	6
SPM 217	217 – 221	157 – 162	~10	6
SPM 226	226 – 230	167 – 171	~10	6
SPM 266	266 – 270	206 – 210	~10	6
SPM 279	279 – 283	218 – 222	~10	6

Installation

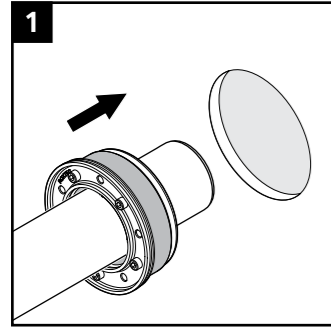

1 Insert the pipe and seal in the aperture.

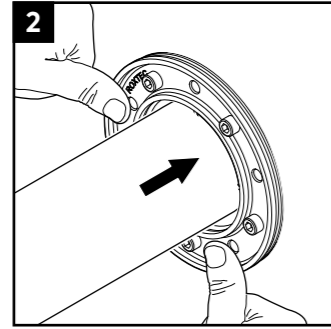

2 Make sure the seal is properly fitted against the inside of the opening.

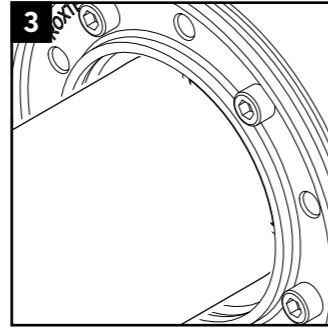

3 Center the pipe in the SPM seal by supporting it externally. There shall be no radial forces on the SPM seal.

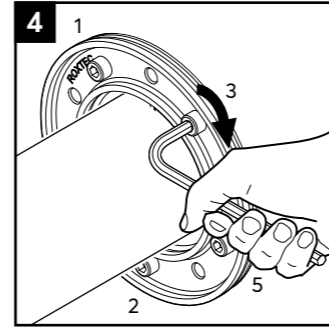

4 Tighten the bolts crosswise in small steps.

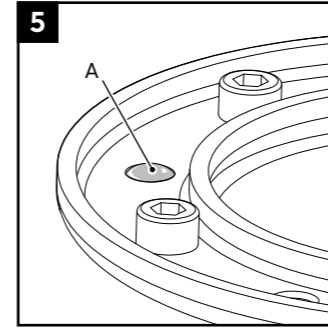

5 Full compression is achieved when the rubber indicator (A) is flush with the steel casing.

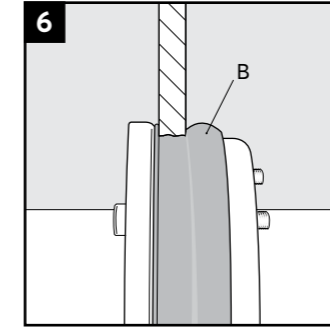

6 The rubber shall bulge (B) on the back side.

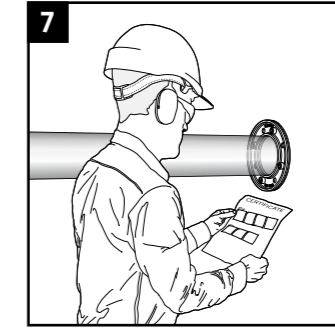

7 Check additional documentation, if applicable.

Disassembly

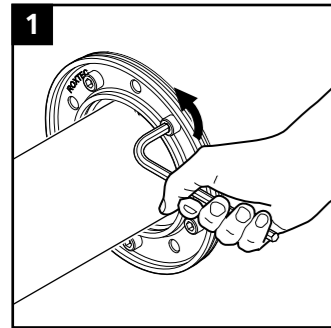

1 Untighten the bolts crosswise in quarter turn increments.

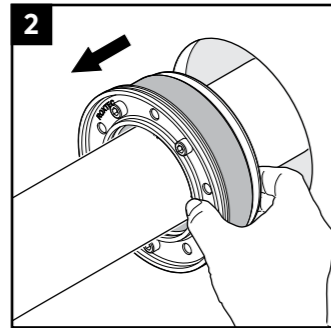

2 Remove the seal from the opening.

Note

- Approvals or certificates may include amendments or limitations related to this application.
- The latest versions of related documents are found at roxtec.com.
- Pipes with a considerable weight need to be supported to prevent damage or subsidence to the seal.
- Pipes shall be parallel to the aperture.

Disclaimer

The Roxtec cable entry sealing system ("the Roxtec system") is a modular-based system of sealing products consisting of different components. Each and every one of the components is necessary for the best performance of the Roxtec system. The Roxtec system has been certified to resist a number of different hazards. Any such certification, and the ability of the Roxtec system to resist such hazards, is dependent on all components that are installed as a part of the Roxtec system. Thus, the certification is not valid and does not apply unless all components installed as part of the Roxtec system are manufactured by or under license from Roxtec ("authorized manufacturer"). Roxtec gives no performance guarantee with respect to the Roxtec system, unless (i) all components installed as part of the Roxtec system are manufactured by an authorized manufacturer and (ii) the purchaser is in compliance with (a), and (b), below.

(a) During storage, the Roxtec system or part thereof, shall be kept indoors in its original packaging at room temperature.

(b) Installation shall be carried out in accordance with Roxtec installation instructions in effect from time to time.

The product information provided by Roxtec does not release the purchaser of the Roxtec system, or part thereof, from the obligation to independently determine the suitability of the products for the intended process, installation and/or use.

Roxtec gives no guarantee for the Roxtec system or any part thereof and assumes no liability for any loss or damage whatsoever, whether direct, indirect, consequential, loss of profit or otherwise, occurred or caused by the Roxtec systems or installations containing components not manufactured by an authorized manufacturer and/or occurred or caused by the use of the Roxtec system in a manner or for an application other than for which the Roxtec system was designed or intended.

Roxtec expressly excludes any implied warranties of merchantability and fitness for a particular purpose and all other express or implied representations and warranties provided by statute or common law. User determines suitability of the Roxtec system for intended use and assumes all risk and liability in connection therewith. In no event shall Roxtec be liable for indirect, consequential, punitive, special, exemplary or incidental damages or losses.*



Roxtec International AB
Box 540, 371 23 Karlskrona, SWEDEN
+46 455 36 67 00, info@roxtec.com
www.roxtec.com