

## Safety information

Roxtec recommends that all installations are performed without facility operation. Follow national regulations and installation codes. Any action affecting the routed service should be performed according to manufacturer recommendations.



## Installation instructions Roxtec CM BG™ B systems

## Components

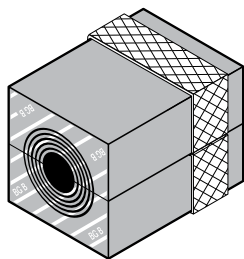

Roxtec CM BG™ B module

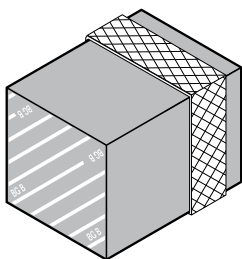

Roxtec CM BG™ B solid module



Roxtec Lubricant

## Roxtec CM BG™ B modules

Measures in millimeters (mm)

Module size	For cable outer diameter min-max
CM 20 BG B	4–14.5
CM 20w40 BG B	3.5–16.5
CM 30w40 BG B	10–25
CM 40 10–32 BG B	9.5–32.5
CM 40 BG B	21.5–34.5

### Note:

The range of the modules indicates the smallest diameter of the exposed cable screen to the largest diameter of the cable jacket. Modules with core can be used as spare parts.

## Roxtec CM BG™ B solid modules

Module size
CM 10w40/0 BG B
CM 20/0 BG B
CM 40/0 BG B

Roxtec CM BG™ B module

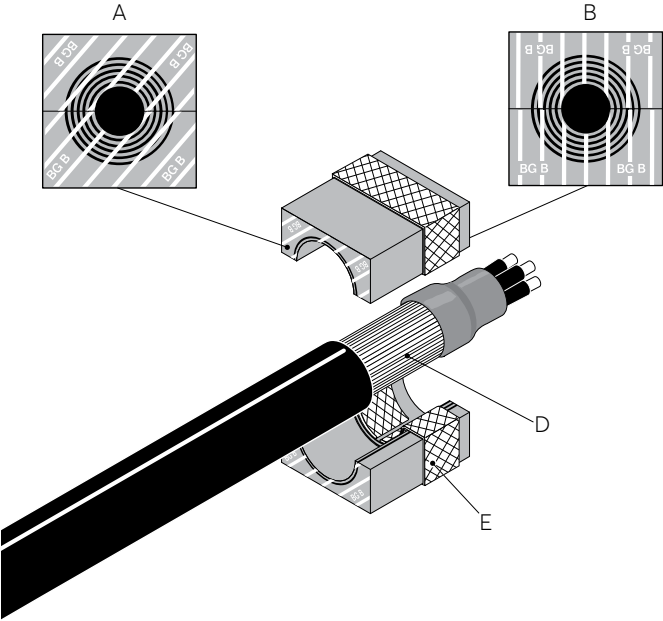

- A: Environmental side
- B: Termination/interior side
- C: Removable layers
- D: Cable armor

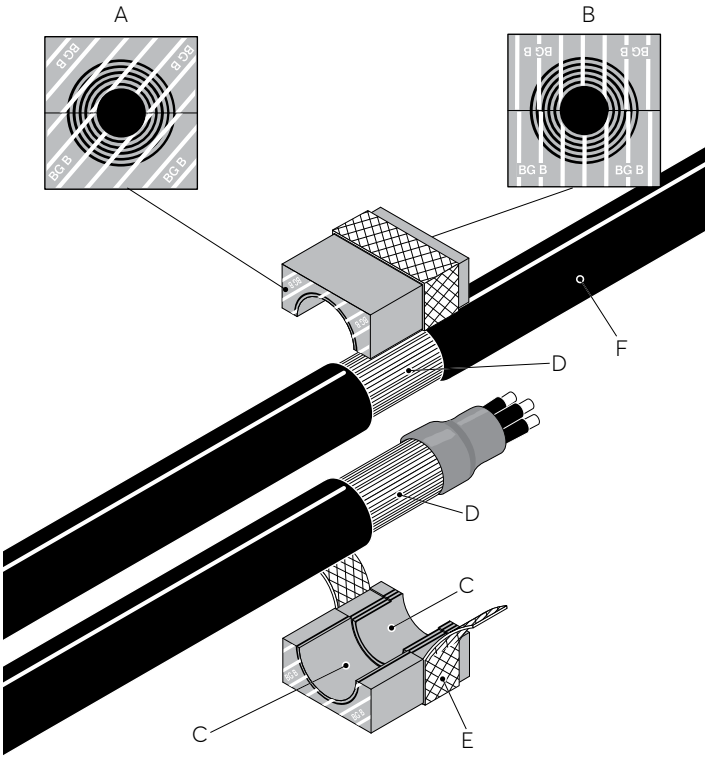

- E: Module braid
- F: Cable jacket

Tools

(not included)

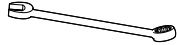

13 mm spanner

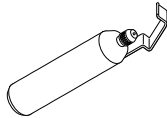

Cable stripper tool.  
Recommended by the cable  
manufacturer

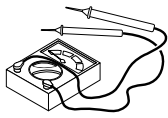

Continuity tester

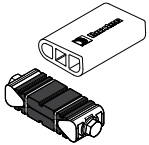

Roxtec  
installation tools

## Installation

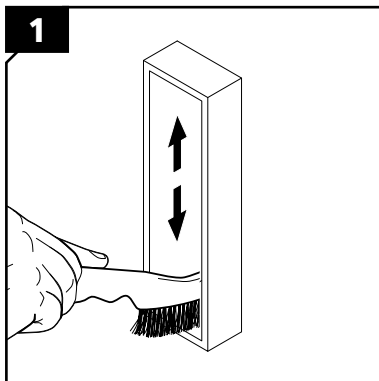

All BG frames must be clean and have electrical contact with protective earth. National regulations apply.

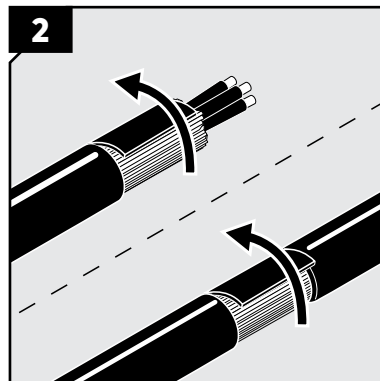

Remove the outer jacket and any plastic foil. The cable armor shall be clean and conductive.

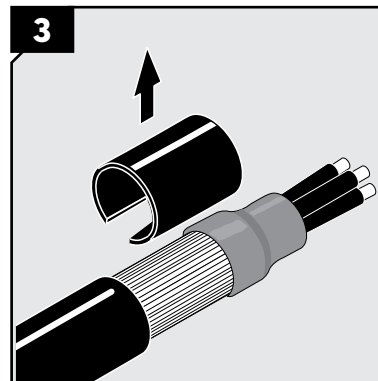

Secure the end of the cable armor. Suggestions for cable preparations are available on [www.roxtec.com](http://www.roxtec.com).

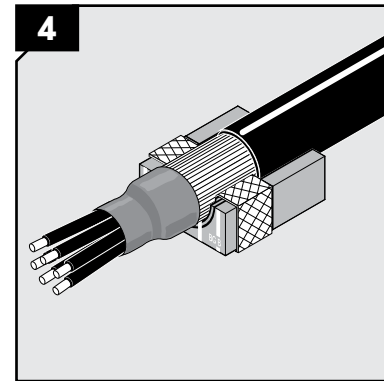

Correct placement of a cable in a CM BG B module. The cable armor shall be visible outside the module.

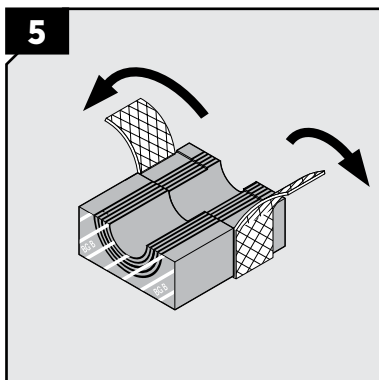

Remove the core and fold out the braid.

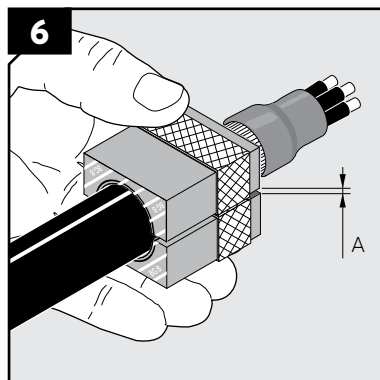

Achieve a gap of 0.1-1.0 mm (A) between the module halves by peeling off layers. The cable armor shall be in contact with the braid.

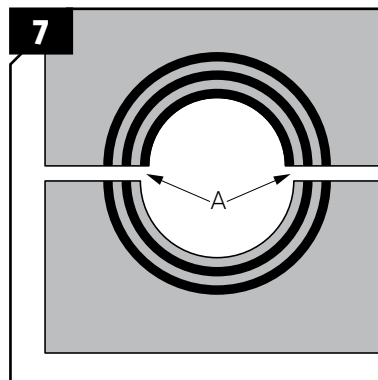

The number of layers may not differ (A) by more than one between the corresponding module halves.

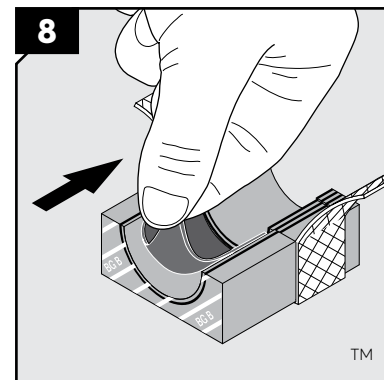

Adapt the layers that are in contact with the cable jacket.

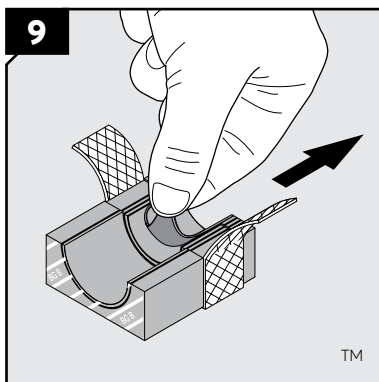

Adapt the layers that are in contact with the cable armor.

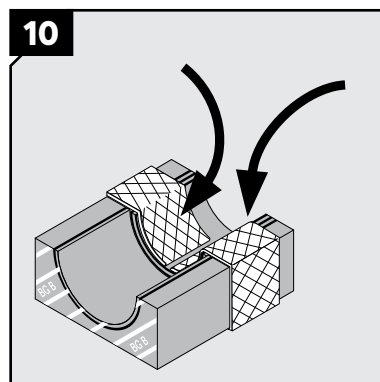

Fold the braid tightly inside the module half.

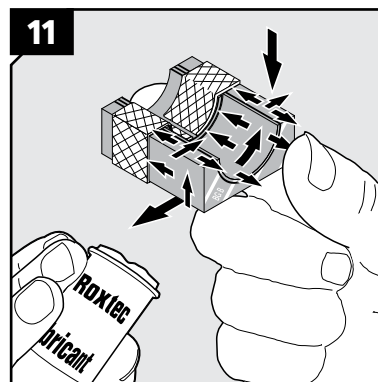

Lubricate the sealing surfaces of all modules. Avoid excess lubricant on the braid.

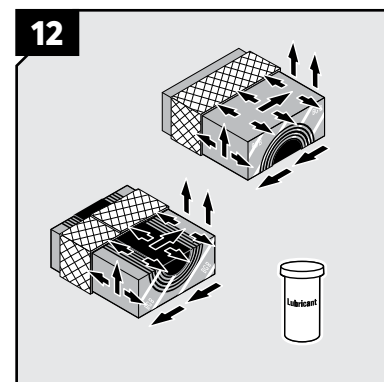

Lubricate the sealing surfaces of the spare modules. Do not remove the core.

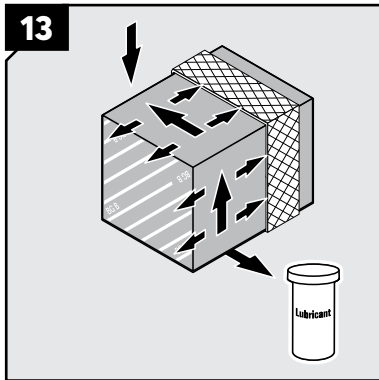

Lubricate the sealing surfaces of the solid modules.

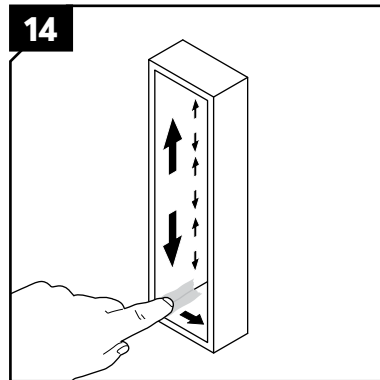

Lubricate the inside surfaces of the frame and especially its corners. Lubricate the area that will be in contact with the module braid sparsely.

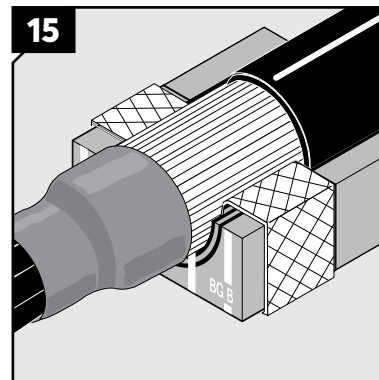

When placing cables in modules, the cable armor shall be visible outside the module at the termination side.

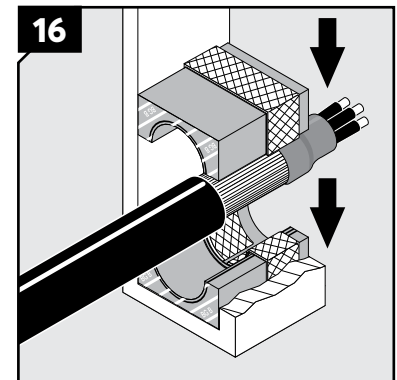

Place cables, according to your packing plan, in the module halves. Place corresponding module halves on top.

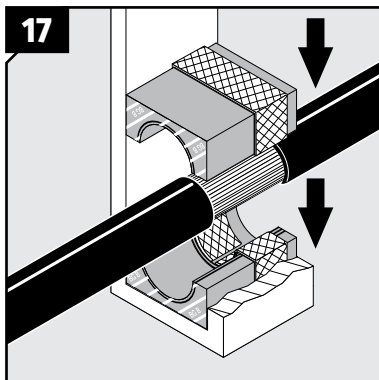

For pass-through cables, cable armor shall be visible on the termination side.

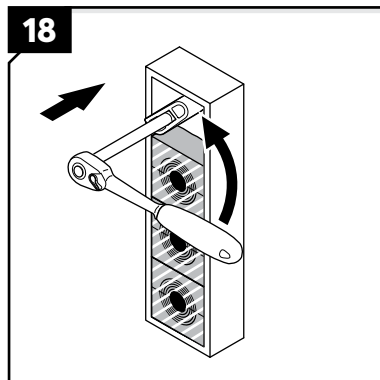

Use a Roxtec pre-compression tool to make space for the compression unit if required.

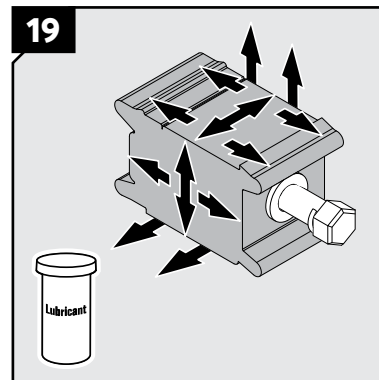

Lubricate the sealing surfaces of the compression unit.

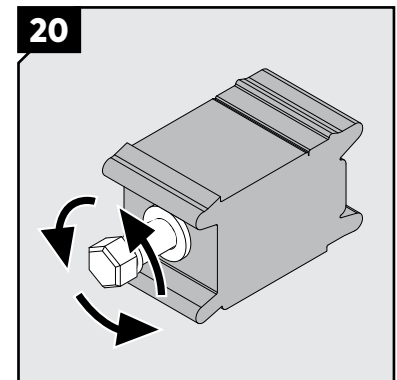

Turn the screw of the compression unit counter clock-wise to full stop before inserting it.

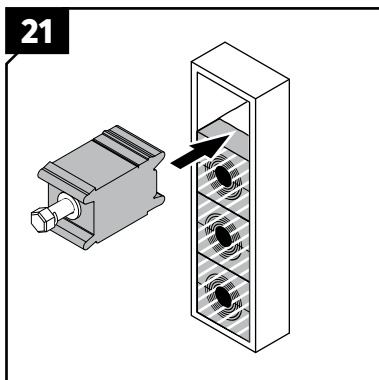

Insert the compression unit.

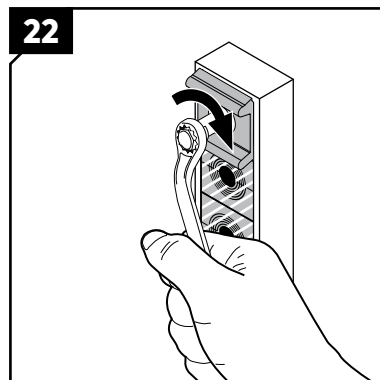

Tighten the compression unit according to the recommended torque in the installation instructions for the transit.

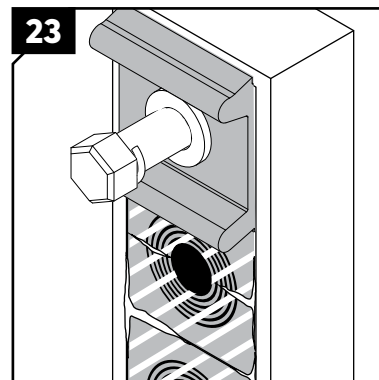

Excess lubricant is a sign of good compression.

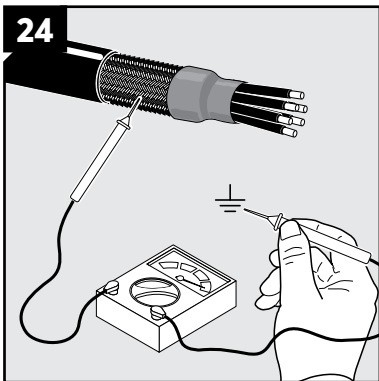

Optional: Verify earth continuity from each cable screen to earth. Use a suitable instrument.

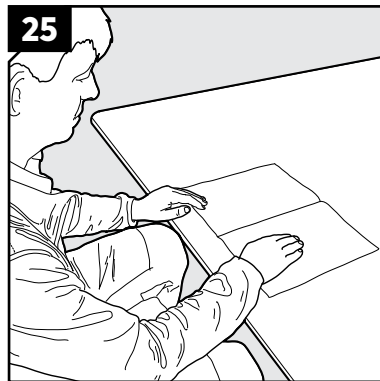

Complete the installation by following the installation instructions for your transit.

Disassembly and reinstallation

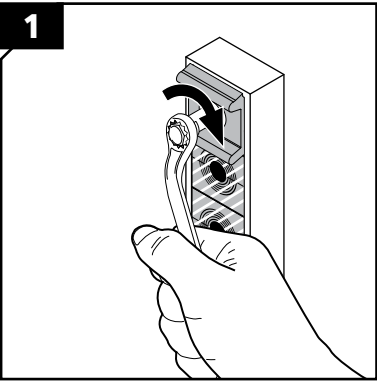

Loosen the screw.

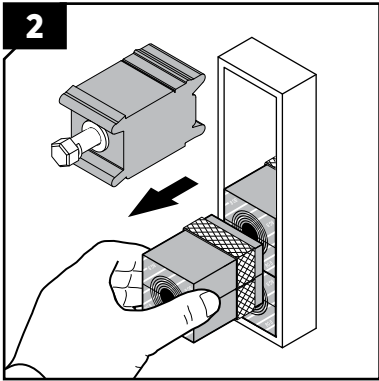

Remove compression unit and modules needed.

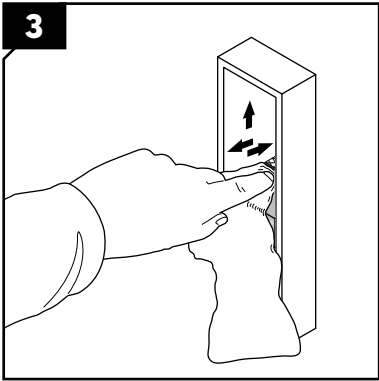

The inside surfaces of the exposed packing space shall be clean and conductive.

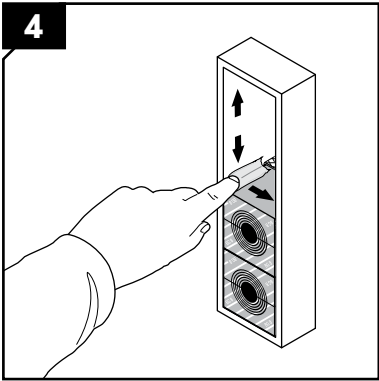

Lubricate the inside surfaces, especially into the corners. Continue the reinstallation.



# Roxtec CM BG™ B modules

Braid conductor properties

Module size	Total braid cross-section mm <sup>2</sup>	Approximately equivalent AWG
CM 20 BG B	8	8
CM 20w40 BG B	4*	11
CM 30w40 BG B	13	6
CM 40 BG B	21	4

\* Per cable

## Note

- Integrated environmental sealing system for bonding and grounding applications. For use with armored cables.
- For optimum reliability, wait 24 hours or longer after installation before exposing the cables or pipes to strain or pressure.
- Corrosion preventing primer must be removed to achieve electrical conductivity, where applicable.
- Cables shall go straight through the frame.
- To simplify installation in frames with more than one opening, fill all openings before tightening the compression units.
- The final complete bonding/grounding installation has to comply with applicable codes and regulations.
- Approvals or certificates may include amendments or limitations related to this application.
- The latest version of this and related documents are found at [roxtec.com](http://roxtec.com).

## Disclaimer

"The Roxtec cable entry sealing system ("the Roxtec system") is a modular-based system of sealing products consisting of different components. Each and every one of the components is necessary for the best performance of the Roxtec system. The Roxtec system has been certified to resist a number of different hazards. Any such certification, and the ability of the Roxtec system to resist such hazards, is dependent on all components that are installed as a part of the Roxtec system. Thus, the certification is not valid and does not apply unless all components installed as part of the Roxtec system are manufactured by or under license from Roxtec ("authorized manufacturer"). Roxtec gives no performance guarantee with respect to the Roxtec system, unless (I) all components installed as part of the Roxtec system are manufactured by an authorized manufacturer and (II) the purchaser is in compliance with (a), and (b), below.

(a) During storage, the Roxtec system or part thereof, shall be kept indoors in its original packaging at room temperature.

(b) Installation shall be carried out in accordance with Roxtec installation instructions in effect from time to time.

The product information provided by Roxtec does not release the purchaser of the Roxtec system, or part thereof, from the obligation to independently determine the suitability of the products for the intended process, installation and/or use.

Roxtec gives no guarantee for the Roxtec system or any part thereof and assumes no liability for any loss or damage whatsoever, whether direct, indirect, consequential, loss of profit or otherwise, occurred or caused by the Roxtec systems or installations containing components not manufactured by an authorized manufacturer and/or occurred or caused by the use of the Roxtec system in a manner or for an application other than for which the Roxtec system was designed or intended.

Roxtec expressly excludes any implied warranties of merchantability and fitness for a particular purpose and all other express or implied representations and warranties provided by statute or common law. User determines suitability of the Roxtec system for intended use and assumes all risk and liability in connection therewith. In no event shall Roxtec be liable for indirect, consequential, punitive, special, exemplary or incidental damages or losses."



Roxtec International AB  
Box 540, 371 23 Karlskrona, SWEDEN  
Phone +46 455 36 67 00, Fax +46 455 820 12  
Email [info@roxtec.com](mailto:info@roxtec.com), [www.roxtec.com](http://www.roxtec.com)